

RAPPRESENTANTE PER L'ITALIA
GORACO SRL - MILANO

www.goraco.com
commerciale@goraco.com

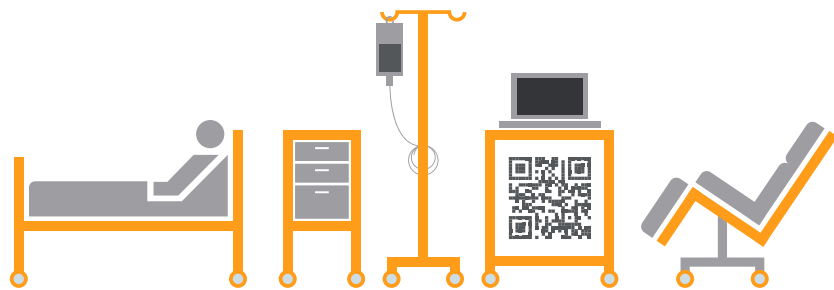

HAION CASTER INDUSTRIAL CO., LTD.
9F-5, No. 27, Lane 61, Sec. 1, Kwang-Fu Rd.,
San Chung Dist., New Taipei City, Taiwan

Tel: +886-2-2999-8831
Fax: +886-2-2999-9131

E-mail: service@haioncaster.com
[http:// www.haioncaster.com](http://www.haioncaster.com)

HAION CASTER INDUSTRIAL CO., LTD.

THE PERFECT SOLUTIONS FOR MOBILITY

Casters & Wheels

No. 28





A Proud History

With more than 3 decades in the industry, cutting edge production facilities and a dedicated team, HAION is the ideal manufacturing partner.

Index

- 05 The Meaning of HAION
- 07 Professional Manufacture
- 09 Accurate Detection
- 11 Comprehensive Formula
- 15 Central Locking System
- 17 Single Wheel Central Locking Castor
- 35 Double Wheel Central Locking Castor
- 43 Medical Equipment Castor
- 51 Stretcher & Institutional Castor
- 67 Wheel Selection Advice
- 69 Accessories



- 71 Wheel Specifications

Single Wheel Central Locking Castor Page 17~34		Double Wheel Central Locking Castor Page 35~44			
P. 19 H499	P. 20 H499	P. 39 H355	P. 40 H355	P. 41 H281	P. 42 H281
P. 21 H399A	P. 22 H399A	P. 43 H282	P. 44 H282		
P. 23 H598	P. 24 H598	Medical Equipment Castor Page 45~52			
P. 25 H396	P. 26 H396	P. 47 H66 (Plate)	P. 48 H66 (Threaded Stem)	P. 49 H66 (Solid Stem)	
P. 27 H395	P. 28 H395	P. 50 H322 (Threaded Stem)	P. 51 H322 (Plate)	P. 52 H322 (Solid Stem)	
P. 29 H491	P. 30 H491	Stretcher & Institutional Castor Page 53~68			
P. 31 H391A	P. 32 H391A	P. 55 H381 (Solid Stem)	P. 56 H381 (Bolt Hole)	P. 57 H382 (Solid Stem)	
P. 33 H392A	P. 34 H392A	P. 58 H382 (Bolt Hole)	P. 59 H35/36 (Plate)	P. 60 H35 (Threaded Stem)	
P. 37 H366	P. 38 H366	P. 61 H35 (Bolt Hole)	P. 62 H35 (Solid Stem)	P. 63 H25/26 (Plate)	
		P. 64 H25 (Threaded Stem)	P. 65 H25 (Bolt Hole)	P. 66 H22 (Plate)	
		P. 67 H22 (Threaded Stem)	P. 68 H22 (Bolt Hole)		

The Meaning of HAION

High quality

With extremely high quality standards, HAION implements strict controls at every stage of the production process. From the screening of plastic raw materials to final injection molding, metal raw material selection, punching and riveting, through to final assembly, we ensure that all of the castors our customers receive are perfect in every way - smooth rolling, durable, and beautifully formed.

Assurance

All of HAION's medical equipment castors conform to the strictest international test standards recognized in Europe, the Americas, Asia, etc. With the HAION commitment to quality, you are assured of receiving the very best castors. We look forward to being of service to you.

Innovation

Our talented, highly experienced design team continues to enhance and improve our existing range of castors and is equally adept at creating new, innovative designs to fit special medical equipment products. With extensive knowledge of the latest industry trends and developments, our mission is to anticipate your requirements and provide the solutions you need.

Outstanding

Our professional, dedicated sales and R&D teams are ready to meet your needs with top quality castor products and prompt, efficient service, making HAION your optimum choice as partner.

No Compromises

In order to keep up with changing trends and the latest technology, we make a continuous effort to provide each of our customers with quality, personalized service that matches their unique requirements. We are happy to provide you with the right castors for your products, assist you in product development and further testing, and develop customized solutions for your new projects.



Professional Manufacture

With more than 30 years in the industry, HAION Caster Industrial Co., Ltd. is Asia's leading manufacturer of castors and wheels. Committed to providing high quality, innovative products for the medical equipment industry, we have established an excellent reputation with customers throughout the world.

HAION manufactures an extensive range of high quality castors and related products. Our professional sales team and worldwide distributors will happily assist you in finding the optimum product for your requirements and budget. With more than 3 decades' experience in the field, HAION is the ideal manufacturing partner.

We believe that the secret to excellent service lies in truly getting to know customers, establishing mutual trust and creating strong, long-term partnerships. Driven by this ideal, we are dedicated to providing each of our customers with the best possible castor solutions.

When you need professional castor solutions, you can rely on HAION, the first choice for leading manufacturers.

We look forward to providing you with our high quality products and exceptional service.



SMOOTH YOUR WAY WITH HAION

The HAION Commitment

HAION is an industry leader, committed to providing superior castor solutions and quality, personalized service for global customers.





Smooth your way
with "HAION"

Quality Assurance

Utilizing the latest high-tech equipment, our skilled staff are dedicated to maintaining the high quality standards HAION is known for.

Accurate Detection

Each of the castors our customers receive has passed through our rigorous quality control system and conforms to European test standards. We also perform special quality tests and experiments according to customer requirements.

Comprehensive Formula















Material Codes

U	PU (Polyurethane)
T	TPR (Thermoplastic rubber)
P	PP (Polypropylene)
N(NY)	Nylon (Polyamide)
E	Electric Conductive
A	Antistatic
B	Precision ball bearing in the wheel
P	Plain bearing in the wheel
I	Insert POM bushing in the wheel

Function Codes

2FT	Swivel + Total Lock
3FN	Swivel + Total Lock + Directional Lock
2OP	Swivel + Total Lock (without neutral)
/N	Swivel + Total Lock (plastic pedal)
/D	Swivel + Directional Lock (plastic pedal)
/X	Swivel + Total Lock (metal pedal)
/S	Swivel + Side brake (wheel lock only)

Key to Symbols

						
Wheel diameter	Wheel width	Wheel width	Overall height	Hub length	Axle hole diameter	Offset
mm	mm	mm	mm	mm	mm	mm
						
Bolt hole	Threaded stem	Solid stem	Plate size	Bolt hole spacing	Bolt hole diameter	Loading
mm	mm	mm	mm	mm	mm	kg

Item Codes

Item Code	fitting	Wheel Diameter	Wheel	Locking Function
H 4 9 9 -1A 150 UPB (2FT)				
H499	A	50	UPB	2FT
H399A	Central Locking Stem	75	TPB	3FN
H598		100	UNB	2OP
H396	B	125	EUPB	/N
H395	Bolt Hole	150	ETPB	/D
H491		200	EUNB	/X
H391A	T	(mm)	AUPB	/S
H392A	Threaded Stem		ATPB	
H366			AUNB	
H281	P		UPP	
H282	Plate		TPP	
H381			UNP	
H382	S		UPI	
H66	Solid Stem		TPI	
H322				
H22	Grip Ring Stem			
H25/26				
H35/36				

B With precision ball bearing in the wheel

P With Plain bearing in the wheel

I With POM bushing in the wheel

Comprehensive Formula

Central Locking Stems

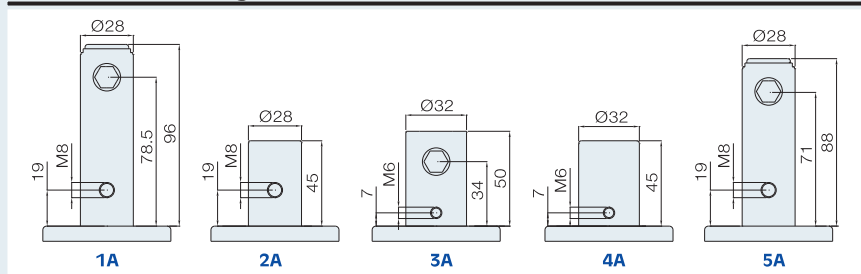

Solid Stems

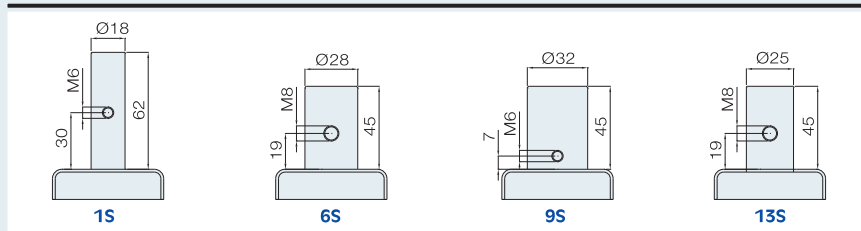

Plates

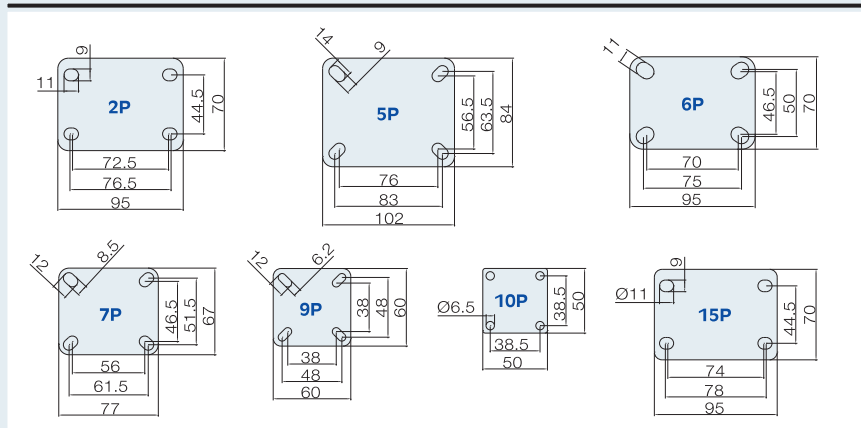

Threaded Stems

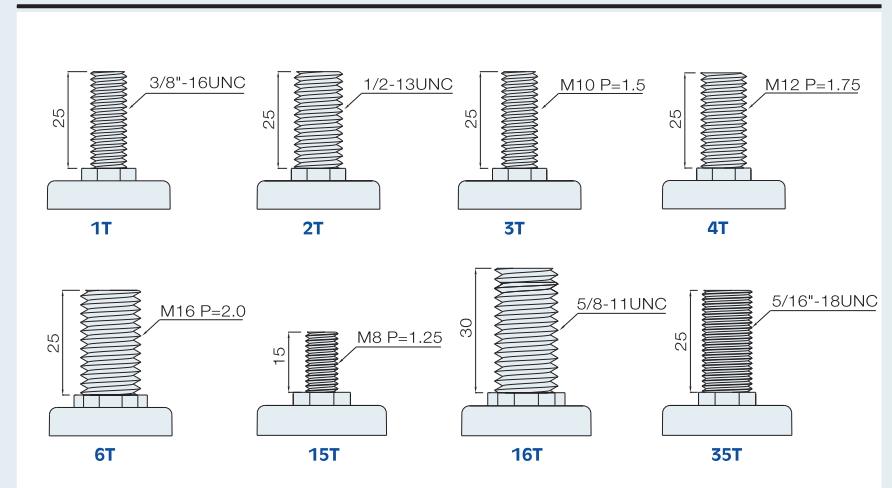

Bolt Holes

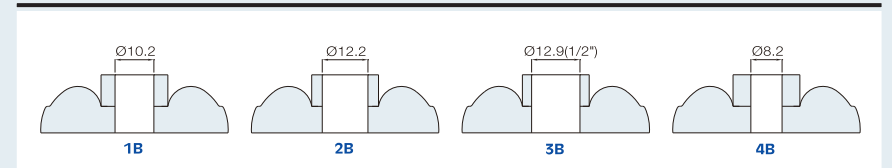

Grip Ring Stems

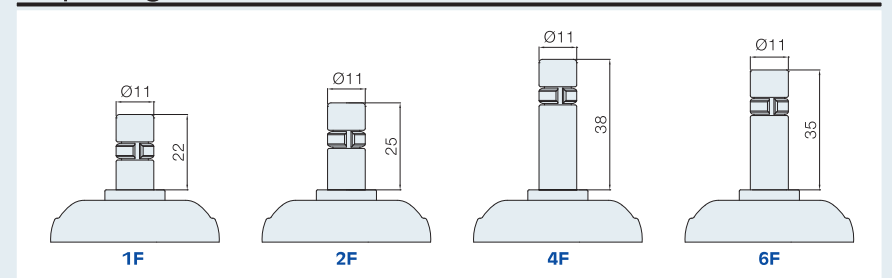

Central Locking System

Recommended Configuration

2FT = Swivel + Total Lock
3FN = Swivel + Total Lock + Directional Lock

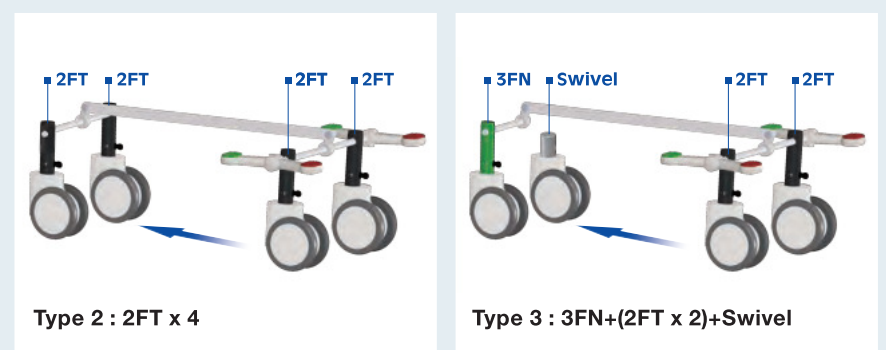
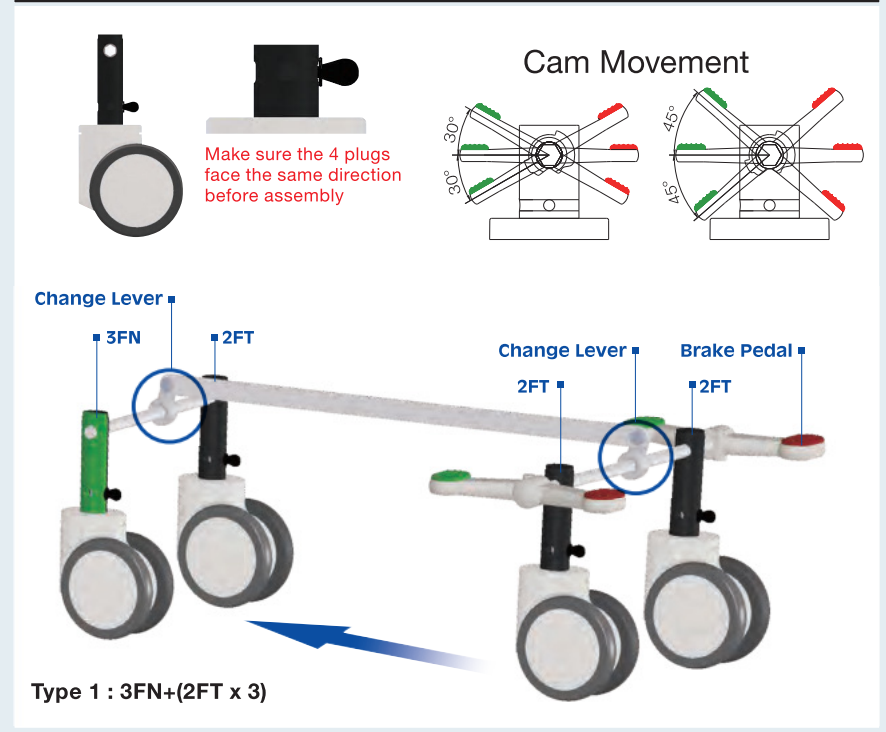

Color Coded by Locking Function



Attention for Assembly

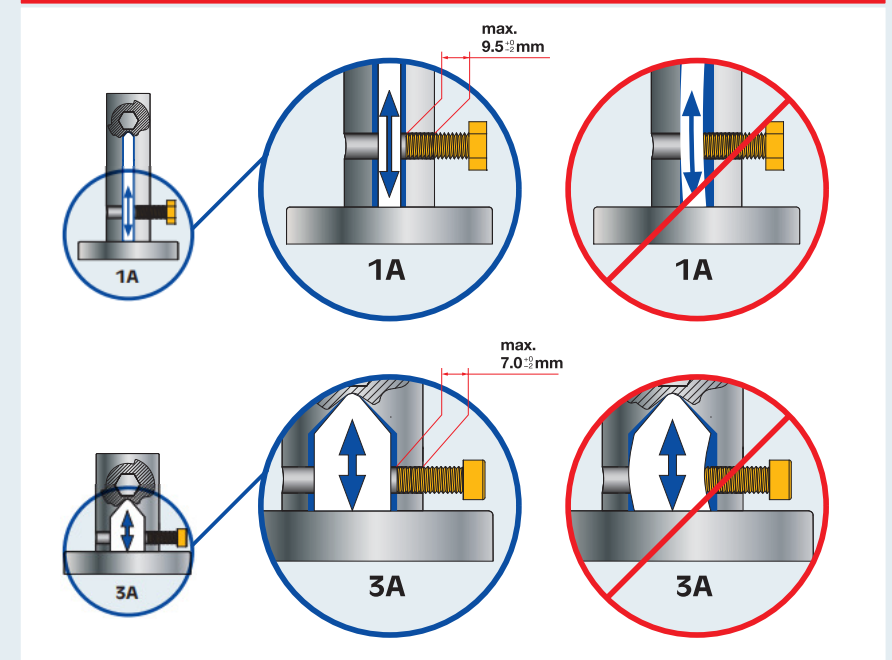

Single Wheel Central Locking Castor

- | | | |
|----------|---------|----------|
| 19 H499 | 25 H396 | 31 H391A |
| 21 H399A | 27 H395 | 33 H392A |
| 23 H598 | 29 H491 | |



▲ H491



▲ H399A



H499 Series

- Pressed steel housing with formed plastic cover, never separate
- Seamless cover keeps dust, hair and water stain outside of the surface and easy cleaned
- Precision ball bearing in both swivel head and wheel
- Cam movement 30° or 45°

Approved by
EN12531

												kg	<input type="checkbox"/> Item Code
mm	mm	mm	mm	mm	mm	mm	mm	mm	mm	mm	mm		

2FT = Swivel + Total Lock													
	125	32	163	42				28 x 96				130	<input type="checkbox"/> H499-1A125UPB(2FT)
	150	32	188	50				28 x 96				150	<input type="checkbox"/> H499-1A150UPB(2FT)
	200	32	236	60				28 x 96				160	<input type="checkbox"/> H499-1A200UPB(2FT)

3FN = Swivel + Total Lock + Directional Lock													
	125	32	163	42				28 x 96				130	<input type="checkbox"/> H499-1A125UPB(3FN)
	150	32	188	50				28 x 96				150	<input type="checkbox"/> H499-1A150UPB(3FN)
	200	32	236	60				28 x 96				160	<input type="checkbox"/> H499-1A200UPB(3FN)

Swivel													
	125	32	163	42				28 x 45				130	<input type="checkbox"/> H499-2A125UPB
	150	32	188	50				28 x 45				150	<input type="checkbox"/> H499-2A150UPB
	200	32	236	60				28 x 45				160	<input type="checkbox"/> H499-2A200UPB

* Static Loading: 3 times

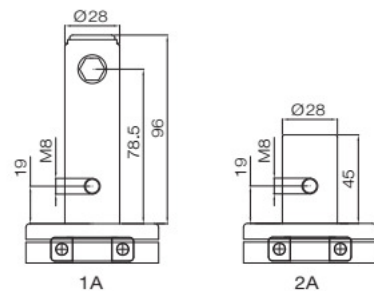

*Color for reference only.

Beige (Off-white)				
Light Grey				
Dark Grey				
Color (Standard)	UPB	TPB	EUPB ETPB	H499W
	Polyurethane on polypropylene with precision ball bearing	Thermoplastic rubber on polypropylene with precision ball bearing	Electric conductive (R<10 ⁴ Ω) Options: Yellow cap or yellow spot on wheel	Washable version castor



H499 Series

- Pressed steel housing with formed plastic cover, never separate
- Seamless cover keeps dust, hair and water stain outside of the surface and easy cleaned
- Precision ball bearing in both swivel head and wheel
- Cam movement 30° or 45°

Approved by
EN12531

												kg	<input type="checkbox"/> Item Code
mm	mm	mm	mm	mm	mm	mm	mm	mm	mm	mm	mm		

2FT = Swivel + Total Lock													
	125	32	163	42				28 x 96				130	<input type="checkbox"/> H499-3A125UPB(2FT)
	150	32	188	50				28 x 96				150	<input type="checkbox"/> H499-3A150UPB(2FT)
	200	32	236	60				28 x 96				160	<input type="checkbox"/> H499-3A200UPB(2FT)

3FN = Swivel + Total Lock + Directional Lock													
	125	32	163	42				28 x 96				130	<input type="checkbox"/> H499-3A125UPB(3FN)
	150	32	188	50				28 x 96				150	<input type="checkbox"/> H499-3A150UPB(3FN)
	200	32	236	60				28 x 96				160	<input type="checkbox"/> H499-3A200UPB(3FN)

Swivel													
	125	32	163	42				28 x 45				130	<input type="checkbox"/> H499-4A125UPB
	150	32	188	50				28 x 45				150	<input type="checkbox"/> H499-4A150UPB
	200	32	236	60				28 x 45				160	<input type="checkbox"/> H499-4A200UPB

* Static Loading: 3 times

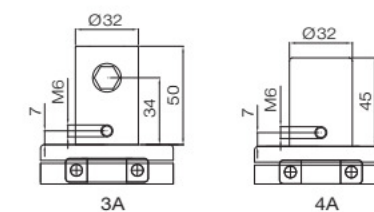

*Color for reference only.

Beige (Off-white)				
Light Grey				
Dark Grey				
Color (Standard)	UPB	TPB	EUPB ETPB	H499W
	Polyurethane on polypropylene with precision ball bearing	Thermoplastic rubber on polypropylene with precision ball bearing	Electric conductive (R<10 ⁴ Ω) Options: Yellow cap or yellow spot on wheel	Washable version castor



H399A Series

- Pressed steel housing with unique cover design, never separate
- All inner locking parts are made of metal, stronger, more durable, and longer life
- Precision ball bearing in both swivel head and wheel
- Cam movement 30° or 45°

Approved by
EN12531

--	--	--	--	--	--	--	--	--	--	--	--	--	--	--	--	--	--	--	--	--	--	--	--	--	--	--	--	--	--	--	--	--	--	--	--	--	--	--	--	--	--	--	--	--	--	--	--	--	--	--	--	--	--	--	--	--	--	--	--	--	--	--	--	--	--	--	--	--	--	--	--	--	--	--	--	--	--	--	--	--	--	--	--	--	--	--	--	--	--	--	--	--	--	--	--	--	--	--	--	--	--	--	--	--	--	--	--	--	--	--	--	--	--	--	--	--	--	--	--	--	--	--	--	--	--	--	--	--	--	--	--	--	--	--	--	--	--	--	--	--	--	--	--	--	--	--	--	--	--	--	--	--	--	--	--	--	--	--	--	--	--	--	--	--	--	--	--	--	--	--	--	--	--	--	--	--	--	--	--	--	--	--	--	--	--	--	--	--	--	--	--	--	--	--	--	--	--	--	--	--	--	--	--	--	--	--	--	--	--	--	--	--	--	--	--	--	--	--	--	--	--	--	--	--	--	--	--	--	--	--	--	--	--	--	--	--	--	--	--	--	--	--	--	--	--	--	--	--	--	--	--	--	--	--	--	--	--	--	--	--	--	--	--	--	--	--	--	--	--	--	--	--	--	--	--	--	--	--	--	--	--	--	--	--	--	--	--	--	--	--	--	--	--	--	--	--	--	--	--	--	--	--	--	--	--	--	--	--	--	--	--	--	--	--	--	--	--	--	--	--	--	--	--	--	--	--	--	--	--	--	--	--	--	--	--	--	--	--	--	--	--	--	--	--	--	--	--	--	--	--	--	--	--	--	--	--	--	--	--	--	--	--	--	--	--	--	--	--	--	--	--	--	--	--	--	--	--	--	--	--	--	--	--	--	--	--	--	--	--	--	--	--	--	--	--	--	--	--	--	--	--	--	--	--	--	--	--	--	--	--	--	--	--	--	--	--	--	--	--	--	--	--	--	--	--	--	--	--	--	--	--	--	--	--	--	--	--	--	--	--	--	--	--	--	--	--	--	--	--	--	--	--	--	--	--	--	--	--	--	--	--	--	--	--	--	--	--	--	--	--	--	--	--	--	--	--	--	--	--	--	--	--	--	--	--	--	--	--	--	--	--	--	--	--	--	--	--	--	--	--	--	--	--	--	--	--	--	--	--	--	--	--	--	--	--	--	--	--	--	--	--	--	--	--	--	--	--	--	--	--	--	--	--	--	--	--	--	--	--	--	--	--	--	--	--	--	--	--	--	--	--	--	--	--	--	--	--	--	--	--	--	--	--	--	--	--	--	--	--	--	--	--	--	--	--	--	--	--	--	--	--	--	--	--	--	--	--	--	--	--	--	--	--	--	--	--	--	--	--	--	--	--	--	--	--	--	--	--	--	--	--	--	--	--	--	--	--	--	--	--	--	--	--	--	--	--	--	--	--	--	--	--	--	--	--	--	--	--	--	--	--	--	--	--	--	--	--	--	--	--	--	--	--	--	--	--	--	--	--	--	--	--	--	--	--	--	--	--	--	--	--	--	--	--	--	--	--	--	--	--	--	--	--	--	--	--	--	--	--	--	--	--	--	--	--	--	--	--	--	--	--	--	--	--	--	--	--	--	--	--	--	--	--	--	--	--	--	--	--	--	--	--	--	--	--	--	--	--	--	--	--	--	--	--	--	--	--	--	--	--	--	--	--	--	--	--	--	--	--	--	--	--	--	--	--	--	--	--	--	--	--	--	--	--	--	--	--	--	--	--	--	--	--	--	--	--	--	--	--	--	--	--	--	--	--	--	--	--	--	--	--	--	--	--	--	--	--	--	--	--	--	--	--	--	--	--	--	--	--	--	--	--	--	--	--	--	--	--	--	--	--	--	--	--	--	--	--	--	--	--	--	--	--	--	--	--	--	--	--	--	--	--	--	--	--	--	--	--	--	--	--	--	--	--	--	--	--	--	--	--	--	--	--	--	--	--

H598 Series

- Special design for heavy-duty hospital bed and stretcher
- Pressed steel housing with injection integrated
- All inner locking parts are made of metal, stronger, more durable, and longer life
- Precision ball bearing in both swivel head and wheel
- Cam movement 30° or 45°

Approved by
EN12531



2FT = Swivel + Total Lock											
125	32	158	42							160	<input type="checkbox"/> H598-1A125UPB(2FT)
150	32	183	50							180	<input type="checkbox"/> H598-1A150UPB(2FT)
200	32	229	60							200	<input type="checkbox"/> H598-1A200UPB(2FT)

3FN = Swivel + Total Lock + Directional Lock											
125	32	158	42							160	<input type="checkbox"/> H598-1A125UPB(3FN)
150	32	183	50							180	<input type="checkbox"/> H598-1A150UPB(3FN)
200	32	229	60							200	<input type="checkbox"/> H598-1A200UPB(3FN)

Swivel											
125	32	158	42							160	<input type="checkbox"/> H598-2A125UPB
150	32	183	50							180	<input type="checkbox"/> H598-2A150UPB
200	32	229	60							200	<input type="checkbox"/> H598-2A200UPB

★ Static Loading: 3 times

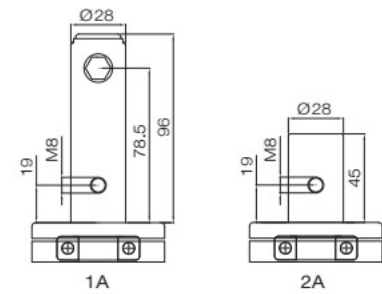

*Color for reference only.



- Color (Standard)**
- UPB** Polyurethane on polypropylene with precision ball bearing
- EUPB** Electric conductive (R<10⁴Ω)
Options: Yellow cap or yellow spot on wheel
- 2OP** Swivel + Total Lock (without neutral)
- H598W** Washable version castor

H598 Series

- Special design for heavy-duty hospital bed and stretcher
- Pressed steel housing with injection integrated
- All inner locking parts are made of metal, stronger, more durable, and longer life
- Precision ball bearing in both swivel head and wheel
- Cam movement 30° or 45°

Approved by
EN12531



2FT = Swivel + Total Lock											
125	32	158	42							160	<input type="checkbox"/> H598-3A125UPB(2FT)
150	32	183	50							180	<input type="checkbox"/> H598-3A150UPB(2FT)
200	32	229	60							200	<input type="checkbox"/> H598-3A200UPB(2FT)

3FN = Swivel + Total Lock + Directional Lock											
125	32	158	42							160	<input type="checkbox"/> H598-3A125UPB(3FN)
150	32	183	50							180	<input type="checkbox"/> H598-3A150UPB(3FN)
200	32	229	60							200	<input type="checkbox"/> H598-3A200UPB(3FN)

Swivel											
125	32	158	42							160	<input type="checkbox"/> H598-4A125UPB
150	32	183	50							180	<input type="checkbox"/> H598-4A150UPB
200	32	229	60							200	<input type="checkbox"/> H598-4A200UPB

★ Static Loading: 3 times

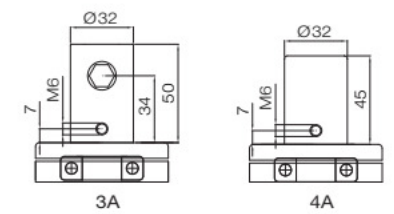

*Color for reference only.



- Color (Standard)**
- UPB** Polyurethane on polypropylene with precision ball bearing
- EUPB** Electric conductive (R<10⁴Ω)
Options: Yellow cap or yellow spot on wheel
- 2OP** Swivel + Total Lock (without neutral)
- H598W** Washable version castor

H396 Series

- Pressed steel housing with unique cover design, never separates
- Double steel ball raceway in swivel head
- Cam movement 30° or 45°

Approved by
EN12530

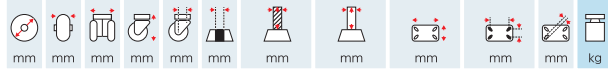

Item Code

2FT = Swivel + Total Lock											
125	32	163	42			28 x 96				100	<input type="checkbox"/> H396-1A125UPB(2FT)
150	32	188	50			28 x 96				100	<input type="checkbox"/> H396-1A150UPB(2FT)
200	32	236	60			28 x 96				120	<input type="checkbox"/> H396-1A200UPB(2FT)

3FN = Swivel + Total Lock + Directional Lock											
125	32	163	42			28 x 96				100	<input type="checkbox"/> H396-1A125UPB(3FN)
150	32	188	50			28 x 96				100	<input type="checkbox"/> H396-1A150UPB(3FN)
200	32	236	60			28 x 96				120	<input type="checkbox"/> H396-1A200UPB(3FN)

Swivel											
125	32	163	42			28 x 45				100	<input type="checkbox"/> H396-2A125UPB
150	32	188	50			28 x 45				100	<input type="checkbox"/> H396-2A150UPB
200	32	236	60			28 x 45				120	<input type="checkbox"/> H396-2A200UPB

★ Static Loading: 2 times

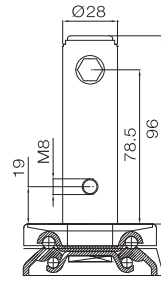

1A

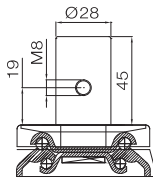

2A

★Color for reference only.



Color (Standard)
 UPB Polyurethane on polypropylene with precision ball bearing
 TPB Thermoplastic rubber on polypropylene with precision ball bearing
 EUPB Electric conductive (R<10⁴Ω)
 ETBP Electric conductive (R<10⁴Ω)
 Options: Yellow cap or yellow spot on wheel
 20P Swivel + Total Lock (without neutral)

H396 Series

- Pressed steel housing with unique cover design, never separates
- Double steel ball raceway in swivel head
- Cam movement 30° or 45°

Approved by
EN12530



Item Code

2FT = Swivel + Total Lock											
125	32	163	42			32 x 50				100	<input type="checkbox"/> H396-3A125UPB(2FT)
150	32	188	50			32 x 50				100	<input type="checkbox"/> H396-3A150UPB(2FT)
200	32	236	60			32 x 50				120	<input type="checkbox"/> H396-3A200UPB(2FT)

3FN = Swivel + Total Lock + Directional Lock											
125	32	163	42			32 x 50				100	<input type="checkbox"/> H396-3A125UPB(3FN)
150	32	188	50			32 x 50				100	<input type="checkbox"/> H396-3A150UPB(3FN)
200	32	236	60			32 x 50				120	<input type="checkbox"/> H396-3A200UPB(3FN)

Swivel											
125	32	163	42			32 x 45				100	<input type="checkbox"/> H396-4A125UPB
150	32	188	50			32 x 45				100	<input type="checkbox"/> H396-4A150UPB
200	32	236	60			32 x 45				120	<input type="checkbox"/> H396-4A200UPB

★ Static Loading: 2 times

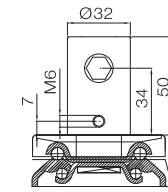

3A

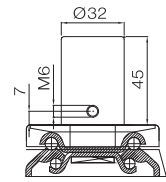

4A

★Color for reference only.



Color (Standard)
 UPB Polyurethane on polypropylene with precision ball bearing
 TPB Thermoplastic rubber on polypropylene with precision ball bearing
 EUPB Electric conductive (R<10⁴Ω)
 ETBP Electric conductive (R<10⁴Ω)
 Options: Yellow cap or yellow spot on wheel
 20P Swivel + Total Lock (without neutral)

H395 Series

- Plastic housing
- Precision ball bearing in both swivel head and wheel
- Cam movement 30° or 45°

Approved by
EN12530

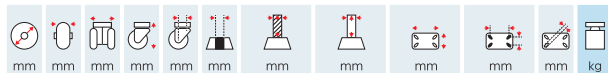

Item Code

2FT = Swivel + Total Lock											
100	32	140	38.5			28 x 96				90	<input type="checkbox"/> H395-1A100UPB(2FT)
125	32	165	42			28 x 96				100	<input type="checkbox"/> H395-1A125UPB(2FT)

3FN = Swivel + Total Lock + Directional Lock											
100	32	140	38.5			28 x 96				90	<input type="checkbox"/> H395-1A100UPB(3FN)
125	32	165	42			28 x 96				100	<input type="checkbox"/> H395-1A125UPB(3FN)

Swivel											
100	32	140	38.5			28 x 45				90	<input type="checkbox"/> H395-2A100UPB
125	32	165	42			28 x 45				100	<input type="checkbox"/> H395-2A125UPB

★ Static Loading: 2 times

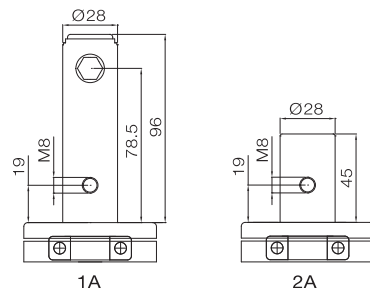

*Color for reference only.

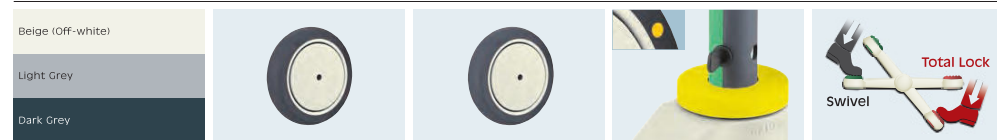

- Color (Standard)**
- UPB** Polyurethane on polypropylene with precision ball bearing
- TPB** Thermoplastic rubber on polypropylene with precision ball bearing
- EUPB** Electric conductive (R<10⁴Ω)
Options: Yellow cap or yellow spot on wheel
- 2OP** Swivel + Total Lock (without neutral)

H395 Series

- Plastic housing
- Precision ball bearing in both swivel head and wheel
- Cam movement 30° or 45°

Approved by
EN12530



Item Code

2FT = Swivel + Total Lock											
100	32	140	38.5			32 x 50				90	H395-3A100UPB(2FT)
125	32	165	42			32 x 50				100	H395-3A125UPB(2FT)

3FN = Swivel + Total Lock + Directional Lock											
100	32	140	38.5			32 x 50				90	H395-3A100UPB(3FN)
125	32	165	42			32 x 50				100	H395-3A125UPB(3FN)

Swivel											
100	32	140	38.5			32 x 45				90	H395-4A100UPB
125	32	165	42			32 x 45				100	H395-4A125UPB

★ Static Loading: 2 times

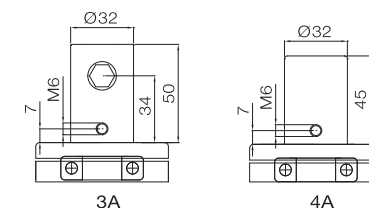

*Color for reference only.

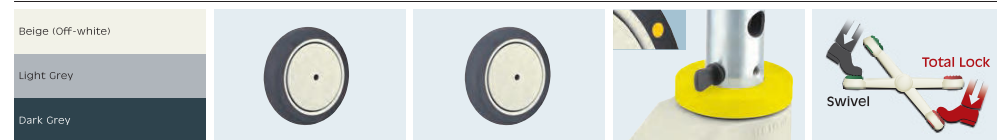

- Color (Standard)**
- UPB** Polyurethane on polypropylene with precision ball bearing
- TPB** Thermoplastic rubber on polypropylene with precision ball bearing
- EUPB** Electric conductive (R<10⁴Ω)
Options: Yellow cap or yellow spot on wheel
- 2OP** Swivel + Total Lock (without neutral)

H491 Series

- Special design for stretcher
- Pressed steel housing
- Round tyre surface, fast, smooth movement
- Precision ball bearing in both swivel head and wheel
- Cam movement 30° or 45°

Approved by
EN12531



Item Code

2FT = Swivel + Total Lock											
200	50	240	60				28 x 96			200	<input type="checkbox"/> H491-1A200UPB(2FT)

3FN = Swivel + Total Lock + Directional Lock											
200	50	240	60				28 x 96			200	<input type="checkbox"/> H491-1A200UPB(3FN)

Swivel											
200	50	240	60				28 x 45			200	<input type="checkbox"/> H491-2A200UPB

★ Static Loading: 3 times

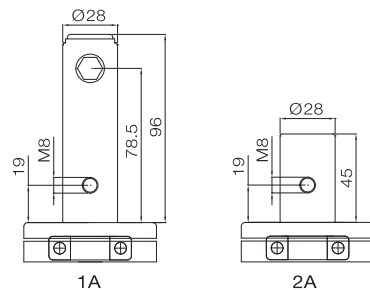

*Color for reference only.



- Powder coated** (Standard)
- Chrome finish** (Optional)
- UPB** Polyurethane on polypropylene with precision ball bearing
- EUPB** Electric conductive (R<10⁴Ω)

H491 Series

- Special design for stretcher
- Pressed steel housing
- Round tyre surface, fast, smooth movement
- Precision ball bearing in both swivel head and wheel
- Cam movement 30° or 45°

Approved by
EN12531



Item Code

2FT = Swivel + Total Lock											
200	50	240	60				32 x 50			200	<input type="checkbox"/> H491-3A200UPB(2FT)

3FN = Swivel + Total Lock + Directional Lock											
200	50	240	60				32 x 50			200	<input type="checkbox"/> H491-3A200UPB(3FN)

Swivel											
200	50	240	60				32 x 45			200	<input type="checkbox"/> H491-4A200UPB

★ Static Loading: 3 times

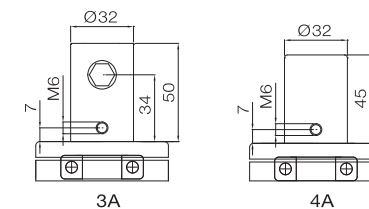

*Color for reference only.



- Powder coated** (Standard)
- Chrome finish** (Optional)
- UPB** Polyurethane on polypropylene with precision ball bearing
- EUPB** Electric conductive (R<10⁴Ω)

H391A Series

- Pressed steel housing
- Precision ball bearing in both swivel head and wheel
- Cam movement 30° or 45°

Approved by
EN12531



Item Code



2FT = Swivel + Total Lock										
100	32	139	38.5		28 x 96			100	<input type="checkbox"/>	H391A-1A100UPB(2FT)
125	32	163	42		28 x 96			125	<input type="checkbox"/>	H391A-1A125UPB(2FT)
150	32	188	50		28 x 96			140	<input type="checkbox"/>	H391A-1A150UPB(2FT)
200	32	236	60		28 x 96			150	<input type="checkbox"/>	H391A-1A200UPB(2FT)



3FN = Swivel + Total Lock + Directional Lock										
100	32	139	38.5		28 x 96			100	<input type="checkbox"/>	H391A-1A100UPB(3FN)
125	32	163	42		28 x 96			125	<input type="checkbox"/>	H391A-1A125UPB(3FN)
150	32	188	50		28 x 96			140	<input type="checkbox"/>	H391A-1A150UPB(3FN)
200	32	236	60		28 x 96			150	<input type="checkbox"/>	H391A-1A200UPB(3FN)



Swivel										
100	32	139	38.5		28 x 45			100	<input type="checkbox"/>	H391A-2A100UPB
125	32	163	42		28 x 45			125	<input type="checkbox"/>	H391A-2A125UPB
150	32	188	50		28 x 45			140	<input type="checkbox"/>	H391A-2A150UPB
200	32	236	60		28 x 45			150	<input type="checkbox"/>	H391A-2A200UPB

★ Static Loading: 3 times

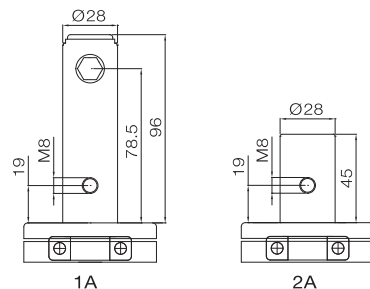

★Color for reference only.



- Zinc finish** (Standard)
- Chrome finish** (Optional)
- UPB** Polyurethane on polypropylene with precision ball bearing
- TPB** Thermoplastic rubber on polypropylene with precision ball bearing
- EUPB/ETPB** Electrically conductive (R<10⁴Ω)
- 2OP** Swivel + Total Lock (without neutral)

H391A Series

- Pressed steel housing
- Precision ball bearing in both swivel head and wheel
- Cam movement 30° or 45°

Approved by
EN12531



Item Code



2FT = Swivel + Total Lock										
100	32	139	38.5		32 x 50			100	<input type="checkbox"/>	H391A-3A100UPB(2FT)
125	32	163	42		32 x 50			125	<input type="checkbox"/>	H391A-3A125UPB(2FT)
150	32	188	50		32 x 50			140	<input type="checkbox"/>	H391A-3A150UPB(2FT)
200	32	236	60		32 x 50			150	<input type="checkbox"/>	H391A-3A200UPB(2FT)



3FN = Swivel + Total Lock + Directional Lock										
100	32	139	38.5		32 x 50			100	<input type="checkbox"/>	H391A-3A100UPB(3FN)
125	32	163	42		32 x 50			125	<input type="checkbox"/>	H391A-3A125UPB(3FN)
150	32	188	50		32 x 50			140	<input type="checkbox"/>	H391A-3A150UPB(3FN)
200	32	236	60		32 x 50			150	<input type="checkbox"/>	H391A-3A200UPB(3FN)



Swivel										
100	32	139	38.5		32 x 45			100	<input type="checkbox"/>	H391A-4A100UPB
125	32	163	42		32 x 45			125	<input type="checkbox"/>	H391A-4A125UPB
150	32	188	50		32 x 45			140	<input type="checkbox"/>	H391A-4A150UPB
200	32	236	60		32 x 45			150	<input type="checkbox"/>	H391A-4A200UPB

★ Static Loading: 3 times

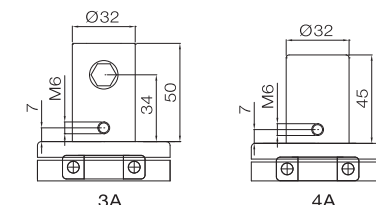

★Color for reference only.



- Zinc finish** (Standard)
- Chrome finish** (Optional)
- UPB** Polyurethane on polypropylene with precision ball bearing
- TPB** Thermoplastic rubber on polypropylene with precision ball bearing
- EUPB/ETPB** Electrically conductive (R<10⁴Ω)
- 2OP** Swivel + Total Lock (without neutral)

H392A Series

- Pressed steel housing
- Double steel ball raceway in swivel head
- Cam movement 30° or 45°

Approved by
EN12530

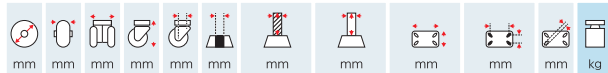

Item Code

2FT = Swivel + Total Lock									
100	32	139	38.5		28 x 96			100	<input type="checkbox"/> H392A-1A100UPB(2FT)
125	32	163	42		28 x 96			100	<input type="checkbox"/> H392A-1A125UPB(2FT)
150	32	188	50		28 x 96			100	<input type="checkbox"/> H392A-1A150UPB(2FT)

3FN = Swivel + Total Lock + Directional Lock									
100	32	139	38.5		28 x 96			100	<input type="checkbox"/> H392A-1A100UPB(3FN)
125	32	163	42		28 x 96			100	<input type="checkbox"/> H392A-1A125UPB(3FN)
150	32	188	50		28 x 96			100	<input type="checkbox"/> H392A-1A150UPB(3FN)

Swivel									
100	32	139	38.5		28 x 45			100	<input type="checkbox"/> H392A-2A100UPB
125	32	163	42		28 x 45			100	<input type="checkbox"/> H392A-2A125UPB
150	32	188	50		28 x 45			100	<input type="checkbox"/> H392A-2A150UPB

* Static Loading: 2 times

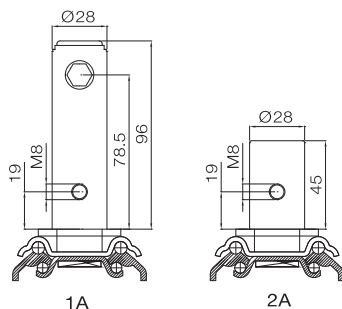

*Color for reference only.



- | | | | | | |
|----------------------------------|------------------------------------|---|---|---|---|
| Zinc finish
(Standard) | Chrome finish
(Optional) | UPB
Polyurethane on polypropylene with precision ball bearing | TPB
Thermoplastic rubber on polypropylene with precision ball bearing | EUPB
ETPB
Electric conductive (R<10 ⁴ Ω) | 20P
Swivel + Total Lock (without neutral) |
|----------------------------------|------------------------------------|---|---|---|---|

H392A Series

- Pressed steel housing
- Double steel ball raceway in swivel head
- Cam movement 30° or 45°

Approved by
EN12530



Item Code

2FT = Swivel + Total Lock									
100	32	139	38.5		32 x 50			100	<input type="checkbox"/> H392A-3A100UPB(2FT)
125	32	163	42		32 x 50			100	<input type="checkbox"/> H392A-3A125UPB(2FT)
150	32	188	50		32 x 50			100	<input type="checkbox"/> H392A-3A150UPB(2FT)

3FN = Swivel + Total Lock + Directional Lock									
100	32	139	38.5		32 x 50			100	<input type="checkbox"/> H392A-3A100UPB(3FN)
125	32	163	42		32 x 50			100	<input type="checkbox"/> H392A-3A125UPB(3FN)
150	32	188	50		32 x 50			100	<input type="checkbox"/> H392A-3A150UPB(3FN)

Swivel									
100	32	139	38.5		32 x 45			100	<input type="checkbox"/> H392A-4A100UPB
125	32	163	42		32 x 45			100	<input type="checkbox"/> H392A-4A125UPB
150	32	188	50		32 x 45			100	<input type="checkbox"/> H392A-4A150UPB

* Static Loading: 2 times

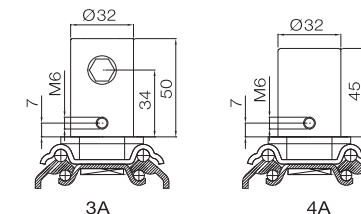

*Color for reference only.



- | | | | | | |
|----------------------------------|------------------------------------|---|---|---|---|
| Zinc finish
(Standard) | Chrome finish
(Optional) | UPB
Polyurethane on polypropylene with precision ball bearing | TPB
Thermoplastic rubber on polypropylene with precision ball bearing | EUPB
ETPB
Electric conductive (R<10 ⁴ Ω) | 20P
Swivel + Total Lock (without neutral) |
|----------------------------------|------------------------------------|---|---|---|---|

Double Wheel Central Locking Castor

37 H366

39 H355

41 H281

43 H282



▲ H366

▲ H366

▲ Brake Pedal



H366 Series

- Pressed steel housing with cover design, water resistance
- All inner locking parts are made of metal, stronger, more durable, and longer life
- Precision ball bearing in both swivel head and wheel
- Cam movement 30° or 45°

Approved by
EN12531

												kg	<input checked="" type="checkbox"/> Item Code
--	--	--	--	--	--	--	--	--	--	--	--	----	---



2FT = Swivel + Total Lock													
100	70	121	28									125	<input type="checkbox"/> H366-1A100UNB(2FT)
125	70	145	37									125	<input type="checkbox"/> H366-1A125UNB(2FT)
150	72	168	45									150	<input type="checkbox"/> H366-1A150UNB(2FT)



3FN = Swivel + Total Lock + Directional Lock													
100	70	121	28									125	<input type="checkbox"/> H366-1A100UNB(3FN)
125	70	145	37									125	<input type="checkbox"/> H366-1A125UNB(3FN)
150	72	168	45									150	<input type="checkbox"/> H366-1A150UNB(3FN)



Swivel													
100	70	121	28									125	<input type="checkbox"/> H366-2A100UNB
125	70	145	37									125	<input type="checkbox"/> H366-2A125UNB
150	72	168	45									150	<input type="checkbox"/> H366-2A150UNB

* Static Loading: 3 times

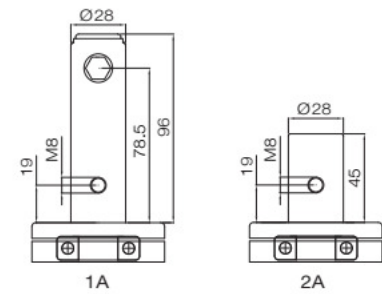

*Color for reference only.



Color (Standard)

UNB Polyurethane on nylon (polyamide) with precision ball bearing

TPB Thermoplastic rubber on polypropylene with precision ball bearing

EUNB ETPB Electric conductive (R<10⁴Ω)
Options: Yellow cap or yellow spot on wheel

H366W Washable version castor



H366 Series

- Pressed steel housing with cover design, water resistance
- All inner locking parts are made of metal, stronger, more durable, and longer life
- Precision ball bearing in both swivel head and wheel
- Cam movement 30° or 45°

Approved by
EN12531

												kg	<input checked="" type="checkbox"/> Item Code
--	--	--	--	--	--	--	--	--	--	--	--	----	---



2FT = Swivel + Total Lock													
100	70	121	28									125	<input type="checkbox"/> H366-3A100UNB(2FT)
125	70	145	37									125	<input type="checkbox"/> H366-3A125UNB(2FT)
150	72	168	45									150	<input type="checkbox"/> H366-3A150UNB(2FT)



3FN = Swivel + Total Lock + Directional Lock													
100	70	121	28									125	<input type="checkbox"/> H366-3A100UNB(3FN)
125	70	145	37									125	<input type="checkbox"/> H366-3A125UNB(3FN)
150	72	168	45									150	<input type="checkbox"/> H366-3A150UNB(3FN)



Swivel													
100	70	121	28									125	<input type="checkbox"/> H366-4A100UNB
125	70	145	37									125	<input type="checkbox"/> H366-4A125UNB
150	72	168	45									150	<input type="checkbox"/> H366-4A150UNB

* Static Loading: 3 times

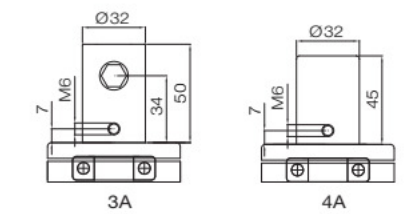

*Color for reference only.



Color (Standard)

UNB Polyurethane on nylon (polyamide) with precision ball bearing

TPB Thermoplastic rubber on polypropylene with precision ball bearing

EUNB ETPB Electric conductive (R<10⁴Ω)
Options: Yellow cap or yellow spot on wheel

H366W Washable version castor

H355 Series

- Pressed steel housing with cover design, water resistance
- Precision ball bearing in both swivel head and wheel
- Cam movement 30° or 45°

Approved by
EN12531

												kg	<input checked="" type="checkbox"/> Item Code
--	--	--	--	--	--	--	--	--	--	--	--	----	---

2FT = Swivel + Total Lock													
125	70	145	37							28 x 96			110 <input type="checkbox"/> H355-1A125TPB(2FT)
150	70	168	45							28 x 96			120 <input type="checkbox"/> H355-1A150TPB(2FT)

3FN = Swivel + Total Lock + Directional Lock													
125	70	145	37							28 x 96			110 <input type="checkbox"/> H355-1A125TPB(3FN)
150	70	168	45							28 x 96			120 <input type="checkbox"/> H355-1A150TPB(3FN)

Swivel													
125	70	145	37							28 x 45			110 <input type="checkbox"/> H355-2A125TPB
150	70	168	45							28 x 45			120 <input type="checkbox"/> H355-2A150TPB

* Static Loading: 3 times

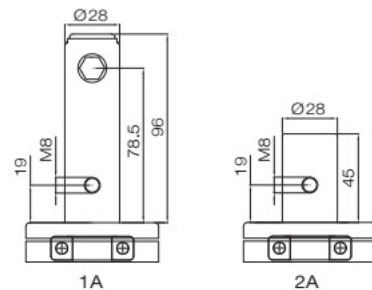

*Color for reference only.



Color (Standard)

TPB
Thermoplastic rubber on polypropylene with precision ball bearing

ETPB
Electric conductive (R<10⁴Ω)
Options: Yellow cap or yellow spot on wheel

H355W
Washable version castor

H355 Series

- Pressed steel housing with cover design, water resistance
- Precision ball bearing in both swivel head and wheel
- Cam movement 30° or 45°

Approved by
EN12531

												kg	<input checked="" type="checkbox"/> Item Code
--	--	--	--	--	--	--	--	--	--	--	--	----	---

2FT = Swivel + Total Lock													
125	70	145	37							32 x 50			110 <input type="checkbox"/> H355-3A125TPB(2FT)
150	70	168	45							32 x 50			120 <input type="checkbox"/> H355-3A150TPB(2FT)

3FN = Swivel + Total Lock + Directional Lock													
125	70	145	37							32 x 50			110 <input type="checkbox"/> H355-3A125TPB(3FN)
150	70	168	45							32 x 50			120 <input type="checkbox"/> H355-3A150TPB(3FN)

Swivel													
125	70	145	37							32 x 45			110 <input type="checkbox"/> H355-4A125TPB
150	70	168	45							32 x 45			120 <input type="checkbox"/> H355-4A150TPB

* Static Loading: 3 times

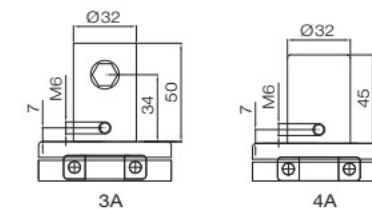

*Color for reference only.



Color (Standard)

TPB
Thermoplastic rubber on polypropylene with precision ball bearing

ETPB
Electric conductive (R<10⁴Ω)
Options: Yellow cap or yellow spot on wheel

H355W
Washable version castor

H281 Series

- Design for home care bed
- Pressed steel housing
- Precision ball bearing in both swivel head and wheel
- Cam movement 30° or 45°

Approved by
EN12531

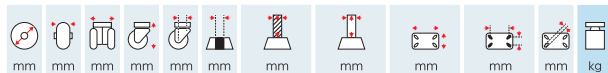

Item Code

2FT = Swivel + Total Lock										
75	50	117	31			28 x 96			100	<input type="checkbox"/> H281-1A075UPB(2FT)

3FN = Swivel + Total Lock + Directional Lock										
75	50	117	31			28 x 96			100	<input type="checkbox"/> H281-1A075UPB(3FN)

Swivel										
75	50	117	31			28 x 45			100	<input type="checkbox"/> H281-2A075UPB

★ Static Loading: 3 times

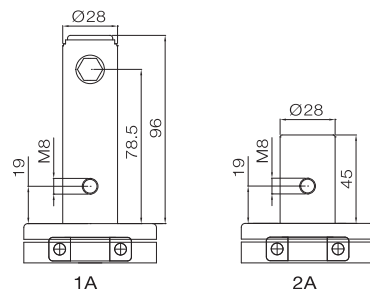

*Color for reference only.

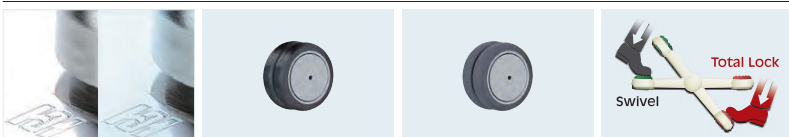

- Zinc finish (Standard)**
- Chrome finish (Optional)**
- UPB** Polyurethane on polypropylene with precision ball bearing
- TPB** Thermoplastic rubber on polypropylene with precision ball bearing
- 2OP** Swivel + Total Lock (without neutral)

H281 Series

- Design for home care bed
- Pressed steel housing
- Precision ball bearing in both swivel head and wheel
- Cam movement 30° or 45°

Approved by
EN12531



Item Code

2FT = Swivel + Total Lock										
75	50	117	31			32 x 50			100	<input type="checkbox"/> H281-3A075UPB(2FT)

3FN = Swivel + Total Lock + Directional Lock										
75	50	117	31			32 x 50			100	<input type="checkbox"/> H281-3A075UPB(3FN)

Swivel										
75	50	117	31			32 x 45			100	<input type="checkbox"/> H281-4A075UPB

★ Static Loading: 3 times

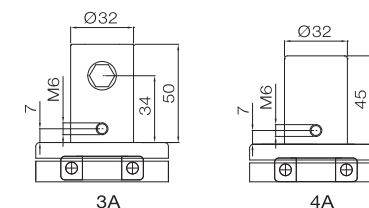

*Color for reference only.



- Zinc finish (Standard)**
- Chrome finish (Optional)**
- UPB** Polyurethane on polypropylene with precision ball bearing
- TPB** Thermoplastic rubber on polypropylene with precision ball bearing
- 2OP** Swivel + Total Lock (without neutral)

H282 Series

- Design for home care bed
- Pressed steel housing
- Double steel ball raceway in swivel head
- Cam movement 30° or 45°

Approved by
EN12531

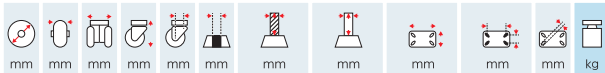

Item Code

2FT = Swivel + Total Lock

50	42	70	21		28 x 96			90	<input type="checkbox"/> H282-1A050UNP(20P)
75	50	110	31		28 x 96			100	<input type="checkbox"/> H282-1A075UPB(2FT)



3FN = Swivel + Total Lock + Directional Lock

75	50	110	31		28 x 96			100	<input type="checkbox"/> H282-1A075UPB(3FN)
----	----	-----	----	--	---------	--	--	-----	---



Swivel

50	42	70	21		28 x 45			90	<input type="checkbox"/> H282-2A050UNP
75	50	110	31		28 x 45			100	<input type="checkbox"/> H282-2A075UPB



★ Static Loading: 3 times

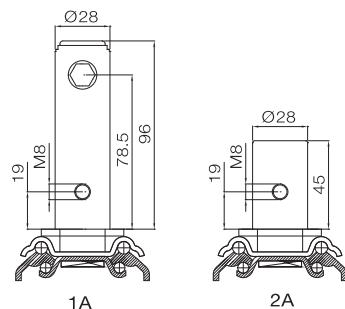

- Zinc finish (Standard)**
- Chrome finish (Optional)**
- UPB** Polyurethane on polypropylene with precision ball bearing
- TPB** Thermoplastic rubber on polypropylene with precision ball bearing
- UNP** Polyurethane on nylon (polyamide) with plain bearing
- 20P** Swivel + Total Lock (without neutral)

H282 Series

- Design for home care bed
- Pressed steel housing
- Double steel ball raceway in swivel head
- Cam movement 30° or 45°

Approved by
EN12531



Item Code

2FT = Swivel + Total Lock

50	42	70	21		32 x 50			90	<input type="checkbox"/> H282-3A050UNP(20P)
75	50	110	31		32 x 50			100	<input type="checkbox"/> H282-3A075UPB(2FT)



3FN = Swivel + Total Lock + Directional Lock

75	50	110	31		32 x 50			100	<input type="checkbox"/> H282-3A075UPB(3FN)
----	----	-----	----	--	---------	--	--	-----	---



Swivel

50	42	70	21		32 x 45			90	<input type="checkbox"/> H282-4A050UNP
75	50	110	31		32 x 45			100	<input type="checkbox"/> H282-4A075UPB



★ Static Loading: 3 times

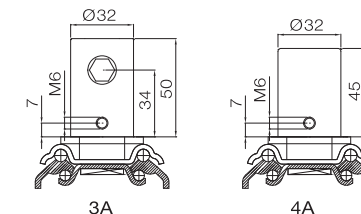

- Zinc finish (Standard)**
- Chrome finish (Optional)**
- UPB** Polyurethane on polypropylene with precision ball bearing
- TPB** Thermoplastic rubber on polypropylene with precision ball bearing
- UNP** Polyurethane on nylon (polyamide) with plain bearing
- 20P** Swivel + Total Lock (without neutral)

Medical Equipment Castor

47 H66/H67

50 H322



▲ H66



▲ H322



▲ H322



▲ H66

H66/H67 Series - Plate

- Top class nylon with fiberglass housing
- Precision ball bearing in both swivel head and wheel
- Stainless steel type (#304) is available (Item code: H66S/H67S)

Approved by
EN12530

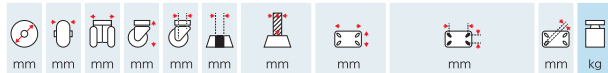

Item Code

Swivel											
100	32	140	37			95 x 70	75 x 50 to 70 x 46.5	11	100	<input type="checkbox"/>	H66-6P100UPB
125	32	165	37			95 x 70	75 x 50 to 70 x 46.5	11	100	<input type="checkbox"/>	H66-6P125UPB



/N = Swivel + Total Lock											
100	32	140	37			95 x 70	75 x 50 to 70 x 46.5	11	100	<input type="checkbox"/>	H66-6P100UPB/N
125	32	165	37			95 x 70	75 x 50 to 70 x 46.5	11	100	<input type="checkbox"/>	H66-6P125UPB/N



/D = Swivel + Directional Lock											
100	32	140	37			95 x 70	75 x 50 to 70 x 46.5	11	100	<input type="checkbox"/>	H66-6P100UPB/D
125	32	165	37			95 x 70	75 x 50 to 70 x 46.5	11	100	<input type="checkbox"/>	H66-6P125UPB/D



Fixed											
100	32	140	37			95 x 70	75 x 50 to 70 x 46.5	11	100	<input type="checkbox"/>	H67-6P100UPB
125	32	165	37			95 x 70	75 x 50 to 70 x 46.5	11	100	<input type="checkbox"/>	H67-6P125UPB



* Static Loading: 2 times

Curved Brake Pedal Easy Lock and Release



Plate Size (mm)			
	Plate Size	Bolt Hole Spacing	Bolt Hole Dia.
5P	102 x 84	83 x 63.5 to 76 x 56.5	9
6P	95 x 70	75 x 50 to 70 x 46.5	11
7P	77 x 67	61.5 x 51.5 to 56 x 46.5	8.5

* Please refer to P.13 for more details.

*Color for reference only.



Color (Standard)

UPB
Polyurethane on polypropylene with precision ball bearing

TPB
Thermoplastic rubber on polypropylene with precision ball bearing

EUPB
ETPB
Electric conductive (R<10³Ω)
Options: Yellow cap or yellow spot on wheel

UPI
PU wheel with POM bushing
TPI
TPR wheel with POM bushing

H66/H67 Series - Threaded Stem

- Top class nylon with fiberglass housing
- Precision ball bearing in both swivel head and wheel
- Stainless steel type (#304) is available (Item code: H66S/H67S)

Approved by
EN12530



Item Code

Swivel													
100	32	137	37				M12 x 25				100	<input type="checkbox"/>	H66-4T100UPB
125	32	162	37				M12 x 25				100	<input type="checkbox"/>	H66-4T125UPB



/N = Swivel + Total Lock													
100	32	137	37				M12 x 25				100	<input type="checkbox"/>	H66-4T100UPB/N
125	32	162	37				M12 x 25				100	<input type="checkbox"/>	H66-4T125UPB/N



/D = Swivel + Directional Lock													
100	32	137	37				M12 x 25				100	<input type="checkbox"/>	H66-4T100UPB/D
125	32	162	37				M12 x 25				100	<input type="checkbox"/>	H66-4T125UPB/D



Fixed													
100	32	137	37				M12 x 25				100	<input type="checkbox"/>	H67-4T100UPB
125	32	162	37				M12 x 25				100	<input type="checkbox"/>	H67-4T125UPB



* Static Loading: 2 times

Curved Brake Pedal Easy Lock and Release



Threaded Stem Size (mm)	
	Dia. x Length
2T	1/2"-13UNC x 25
3T	M10 x 25 P=1.50
4T	M12 x 25 P=1.75
6T	M16 x 25 P=2.00

* Please refer to P.14 for more details.

*Color for reference only.



Color (Standard)

UPB
Polyurethane on polypropylene with precision ball bearing

TPB
Thermoplastic rubber on polypropylene with precision ball bearing

EUPB
ETPB
Electric conductive (R<10³Ω)
Options: Yellow cap or yellow spot on wheel

UPI
PU wheel with POM bushing
TPI
TPR wheel with POM bushing

H66/H67 Series - Solid Stem

- Top class nylon with fiberglass housing
- Precision ball bearing in both swivel head and wheel
- Stainless steel type (#304) is available (Item code: H66S/H67S)

Approved by
EN12530

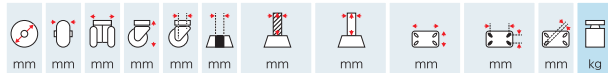

Swivel											kg	Item Code
100	32	137	37					28 x 45			100	<input type="checkbox"/> H66-6S100UPB
125	32	162	37					28 x 45			100	<input type="checkbox"/> H66-6S125UPB



/N = Swivel + Total Lock											kg	Item Code
100	32	137	37					28 x 45			100	<input type="checkbox"/> H66-6S100UPB/N
125	32	162	37					28 x 45			100	<input type="checkbox"/> H66-6S125UPB/N



/D = Swivel + Directional Lock											kg	Item Code
100	32	137	37					28 x 45			100	<input type="checkbox"/> H66-6S100UPB/D
125	32	162	37					28 x 45			100	<input type="checkbox"/> H66-6S125UPB/D



Fixed											kg	Item Code
100	32	137	37					28 x 45			100	<input type="checkbox"/> H67-6S100UPB
125	32	162	37					28 x 45			100	<input type="checkbox"/> H67-6S125UPB



Curved Brake Pedal Easy Lock and Release



Solid Stem Size (mm) * Static Loading: 2 times

	Dia. x Length
1S	18 x 62
6S	28 x 45
9S	32 x 45
13S	25 x 45

* Please refer to P.13 for more details.

*Color for reference only.



Color (Standard)	UPB	TPB	EUPB	ETPB	UPI
Beige (Off-white)	Polyurethane on polypropylene with precision ball bearing	Thermoplastic rubber on polypropylene with precision ball bearing	Electric conductive (R<10 ⁴ Ω)	Electric conductive (R<10 ⁴ Ω)	PU wheel with POM bushing
Light Grey			Options: Yellow cap or yellow spot on wheel		TPR wheel with POM bushing
Dark Grey					

H322 Series - Threaded Stem

- Design for high class medical equipment
- Precision ball bearing in both swivel head and wheel
- Brake design for both wheel lock and directional lock
- MRI castor is available

Approved by
EN12530



Swivel											kg	Item Code
75	62	91	22					M12 x 25			70	<input type="checkbox"/> H322-4T075UNB
100	74	119	31					M12 x 25			110	<input type="checkbox"/> H322-4T100UNB
125	74	142	38					M12 x 25			120	<input type="checkbox"/> H322-4T125UNB



/N = Swivel + Total Lock											kg	Item Code
75	62	91	22					M12 x 25			70	<input type="checkbox"/> H322-4T075UNB/N
100	74	119	31					M12 x 25			110	<input type="checkbox"/> H322-4T100UNB/N
125	74	142	38					M12 x 25			120	<input type="checkbox"/> H322-4T125UNB/N



* Static Loading: 2 times

Curved Brake Pedal Easy Lock and Release



Threaded Stem Size (mm)

	Dia. x Length
4T	M12 x 25 P=1.75
6T	M16 x 25 P=2.00

* Please refer to P.14 for more details.

*Color for reference only.



Color (Standard)	UNB	TPB	EUNB	ETPB	H322A-MRI castor
Beige (Off-white)	Polyurethane on nylon (polyamide) with precision ball bearing	Thermoplastic rubber on polypropylene with precision ball bearing	Non-Ferromagnetic bearing (in both swivel head and wheel) or plain bearing (neither swivel head nor wheel)	Electric conductive (R<10 ⁴ Ω)	Options: Yellow cap or yellow spot on wheel
Grey					
Black					

H322 Series - Plate

- Design for high class medical equipment
- Precision ball bearing in both swivel head and wheel
- Brake design for both wheel lock and directional lock

Approved by
EN12530

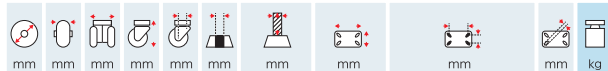

Item Code

Swivel

75	62	93	22			95 x 70	75 x 50 to 70 x 46.5	11	70	<input type="checkbox"/> H322-6P075UNB
100	74	122	31			95 x 70	75 x 50 to 70 x 46.5	11	110	<input type="checkbox"/> H322-6P100UNB
125	74	145	38			95 x 70	75 x 50 to 70 x 46.5	11	120	<input type="checkbox"/> H322-6P125UNB



/N = Swivel + Total Lock

75	62	93	22			95 x 70	75 x 50 to 70 x 46.5	11	70	<input type="checkbox"/> H322-6P075UNB/N
100	74	122	31			95 x 70	75 x 50 to 70 x 46.5	11	110	<input type="checkbox"/> H322-6P100UNB/N
125	74	145	38			95 x 70	75 x 50 to 70 x 46.5	11	120	<input type="checkbox"/> H322-6P125UNB/N



/D = Swivel + Directional Lock

75	62	93	22			95 x 70	75 x 50 to 70 x 46.5	11	70	<input type="checkbox"/> H322-6P075UNB/D
100	74	122	31			95 x 70	75 x 50 to 70 x 46.5	11	110	<input type="checkbox"/> H322-6P100UNB/D
125	74	145	38			95 x 70	75 x 50 to 70 x 46.5	11	120	<input type="checkbox"/> H322-6P125UNB/D



* Static Loading: 2 times

Curved Brake Pedal Easy Lock and Release

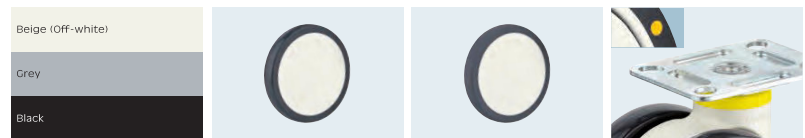

Plate Size (mm)

	Plate Size	Bolt Hole Spacing	Bolt Hole Dia.
5P	102 x 84	83 x 63.5 to 76 x 56.5	9
6P	95 x 70	75 x 50 to 70 x 46.5	11
7P	77 x 67	61.5 x 51.5 to 56 x 46.5	8.5

* Please refer to P.13 for more details.

*Color for reference only.



Color (Standard)

UNB
Polyurethane on nylon (polyamide) with precision ball bearing

TPB
Thermoplastic rubber on polypropylene with precision ball bearing

EUNB
ETPB
Electric conductive (R<10⁴Ω)
Options: Yellow cap or yellow spot on wheel

H322 Series - Solid Stem

- Design for high class medical equipment
- Precision ball bearing in both swivel head and wheel
- Brake design for both wheel lock and directional lock

Approved by
EN12530



Item Code

Swivel

75	62	88	22							28 x 45										70	<input type="checkbox"/> H322-6S075UNB	
100	74	118	31							28 x 45											110	<input type="checkbox"/> H322-6S100UNB
125	74	141	38							28 x 45											120	<input type="checkbox"/> H322-6S125UNB



/N = Swivel + Total Lock

75	62	88	22							28 x 45											70	<input type="checkbox"/> H322-6S075UNB/N	
100	74	118	31							28 x 45												110	<input type="checkbox"/> H322-6S100UNB/N
125	74	141	38							28 x 45												120	<input type="checkbox"/> H322-6S125UNB/N



/D = Swivel + Directional Lock

75	62	88	22							28 x 45												70	<input type="checkbox"/> H322-6S075UNB/D	
100	74	118	31							28 x 45													110	<input type="checkbox"/> H322-6S100UNB/D
125	74	141	38							28 x 45													120	<input type="checkbox"/> H322-6S125UNB/D



* Static Loading: 2 times

Curved Brake Pedal Easy Lock and Release



Solid Stem Size (mm)

	Dia. x Length
15	18 x 62
6S	28 x 45
9S	32 x 45
13S	25 x 45

* Please refer to P.13 for more details.

*Color for reference only.

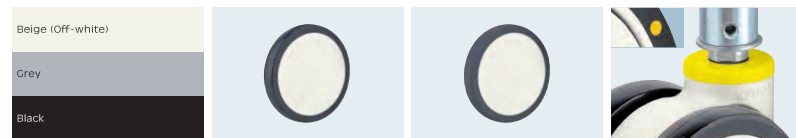

Color (Standard)

UNB
Polyurethane on nylon (polyamide) with precision ball bearing

TPB
Thermoplastic rubber on polypropylene with precision ball bearing

EUNB
ETPB
Electric conductive (R<10⁴Ω)
Options: Yellow cap or yellow spot on wheel

Stretcher & Institutional Castor

- 55 H381
- 57 H382
- 59 H35/36
- 63 H25/26
- 66 H22



H381 Series – Solid Stem

- Pressed steel housing
- Precision ball bearing in both swivel head and wheel
- Stainless steel type (#304) is available (Item code: H381S)

Approved by
EN12530

mm	mm	mm	mm	mm	mm	mm	mm	mm	mm	mm	mm	kg	Item Code
----	----	----	----	----	----	----	----	----	----	----	----	----	-----------

Swivel

125	32	163	36									130	<input type="checkbox"/> H381-6S125UPB
150	32	192	40									140	<input type="checkbox"/> H381-6S150UPB
200	32	248	48									150	<input type="checkbox"/> H381-6S200UPB



/N = Swivel + Total Lock

125	32	163	36									130	<input type="checkbox"/> H381-6S125UPB/N
150	32	192	40									140	<input type="checkbox"/> H381-6S150UPB/N
200	32	248	48									150	<input type="checkbox"/> H381-6S200UPB/N



/D = Swivel + Directional Lock

125	32	163	36									130	<input type="checkbox"/> H381-6S125UPB/D
150	32	192	40									140	<input type="checkbox"/> H381-6S150UPB/D
200	32	248	48									150	<input type="checkbox"/> H381-6S200UPB/D



★ Static Loading: 2 times

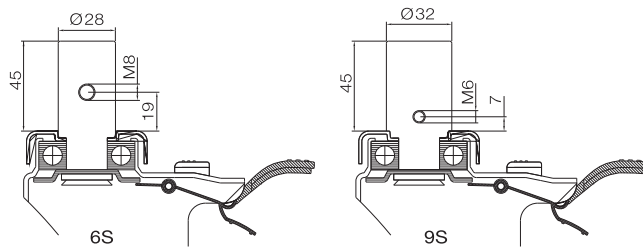

★ Color for reference only.



- Zinc finish** (Standard)
Chrome finish (Optional)
- Pedal Options**
/D = Swivel + Directional Lock (plastic pedal)
/N = Swivel + Total Lock (plastic pedal)
/X = Swivel + Total Lock (metal pedal)
- UPB**
PU wheel with precision ball bearing
TPB
TPR wheel with precision ball bearing
- EUPB**
ETPB
Electric conductive (R<10⁴Ω)

H381 Series – Bolt Hole

- Pressed steel housing
- Precision ball bearing in both swivel head and wheel
- Stainless steel type (#304) is available (Item code: H381S)

Approved by
EN12530

mm	mm	mm	mm	mm	mm	mm	mm	mm	mm	mm	mm	kg	Item Code
----	----	----	----	----	----	----	----	----	----	----	----	----	-----------

Swivel

125	32	163	36	12.2								130	<input type="checkbox"/> H381-2B125UPB
150	32	192	40	12.2								140	<input type="checkbox"/> H381-2B150UPB
200	32	248	48	12.2								150	<input type="checkbox"/> H381-2B200UPB



/N = Swivel + Total Lock

125	32	163	36	12.2								130	<input type="checkbox"/> H381-2B125UPB/N
150	32	192	40	12.2								140	<input type="checkbox"/> H381-2B150UPB/N
200	32	248	48	12.2								150	<input type="checkbox"/> H381-2B200UPB/N



/D = Swivel + Directional Lock

125	32	163	36	12.2								130	<input type="checkbox"/> H381-2B125UPB/D
150	32	192	40	12.2								140	<input type="checkbox"/> H381-2B150UPB/D
200	32	248	48	12.2								150	<input type="checkbox"/> H381-2B200UPB/D



★ Static Loading: 2 times

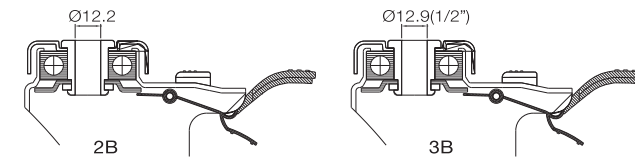

★ Color for reference only.



- Zinc finish** (Standard)
Chrome finish (Optional)
- Pedal Options**
/D = Swivel + Directional Lock (plastic pedal)
/N = Swivel + Total Lock (plastic pedal)
/X = Swivel + Total Lock (metal pedal)
- UPB**
PU wheel with precision ball bearing
TPB
TPR wheel with precision ball bearing
- EUPB**
ETPB
Electric conductive (R<10⁴Ω)

H382 Series – Solid Stem

- Pressed steel housing
- Double steel ball raceway in swivel head
- Stainless steel type (#304) is available (Item code: H382S)

Approved by
EN12530

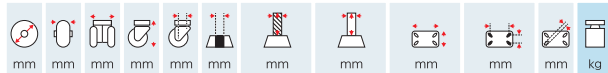

Item Code

Swivel												
mm	mm	mm	mm	mm	mm	mm	mm	mm	mm	mm	kg	
125	32		159	32					28 x 45		130	<input type="checkbox"/> H382-6S125UPB
150	32		187	37					28 x 45		140	<input type="checkbox"/> H382-6S150UPB
200	32		243	45					28 x 45		150	<input type="checkbox"/> H382-6S200UPB

/N = Swivel + Total Lock												
mm	mm	mm	mm	mm	mm	mm	mm	mm	mm	mm	kg	
125	32		159	32					28 x 45		130	<input type="checkbox"/> H382-6S125UPB/N
150	32		187	37					28 x 45		140	<input type="checkbox"/> H382-6S150UPB/N
200	32		243	45					28 x 45		150	<input type="checkbox"/> H382-6S200UPB/N

/D = Swivel + Directional Lock												
mm	mm	mm	mm	mm	mm	mm	mm	mm	mm	mm	kg	
125	32		159	32					28 x 45		130	<input type="checkbox"/> H382-6S125UPB/D
150	32		187	37					28 x 45		140	<input type="checkbox"/> H382-6S150UPB/D
200	32		243	45					28 x 45		150	<input type="checkbox"/> H382-6S200UPB/D

★ Static Loading: 2 times

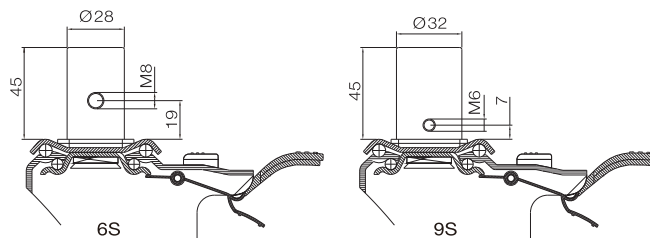

*Color for reference only.



- Zinc finish** (Standard)
- Chrome finish** (Optional)
- Pedal Options**
 - /D = Swivel + Directional Lock (plastic pedal)
 - /N = Swivel + Total Lock (plastic pedal)
 - /X = Swivel + Total Lock (metal pedal)
- UPB** PU wheel with precision ball bearing
- TPB** TPR wheel with precision ball bearing
- EUPB** Electric conductive (R<10⁴Ω)

H382 Series – Bolt Hole

- Pressed steel housing
- Double steel ball raceway in swivel head
- Stainless steel type (#304) is available (Item code: H382S)

Approved by
EN12530



Item Code

Swivel												
mm	mm	mm	mm	mm	mm	mm	mm	mm	mm	mm	kg	
125	32		159	32	12.2						130	<input type="checkbox"/> H382-2B125UPB
150	32		187	37	12.2						140	<input type="checkbox"/> H382-2B150UPB
200	32		243	45	12.2						150	<input type="checkbox"/> H382-2B200UPB

/N = Swivel + Total Lock												
mm	mm	mm	mm	mm	mm	mm	mm	mm	mm	mm	kg	
125	32		159	32	12.2						130	<input type="checkbox"/> H382-2B125UPB/N
150	32		187	37	12.2						140	<input type="checkbox"/> H382-2B150UPB/N
200	32		243	45	12.2						150	<input type="checkbox"/> H382-2B200UPB/N

/D = Swivel + Directional												
mm	mm	mm	mm	mm	mm	mm	mm	mm	mm	mm	kg	
125	32		159	32	12.2						130	<input type="checkbox"/> H382-2B125UPB/D
150	32		187	37	12.2						140	<input type="checkbox"/> H382-2B150UPB/D
200	32		243	45	12.2						150	<input type="checkbox"/> H382-2B200UPB/D

★ Static Loading: 2 times

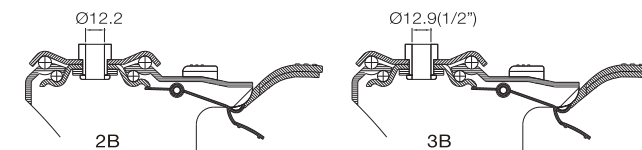

*Color for reference only.



- Zinc finish** (Standard)
- Chrome finish** (Optional)
- Pedal Options**
 - /D = Swivel + Directional Lock (plastic pedal)
 - /N = Swivel + Total Lock (plastic pedal)
 - /X = Swivel + Total Lock (metal pedal)
- UPB** PU wheel with precision ball bearing
- TPB** TPR wheel with precision ball bearing
- EUPB** Electric conductive (R<10⁴Ω)

H35 Series - Bolt Hole

- Pressed steel housing
- Double steel ball raceway in swivel head
- Stainless steel type (#304) is available (Item code: H35S)

Approved by
EN12530

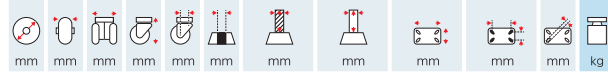

Item Code

Swivel											
75	32	111	45	12.2						80	<input type="checkbox"/> H35-2B075TPB
75	32	111	45	12.2						80	<input type="checkbox"/> H35-2B075UPB
75	32	111	45	12.2						150	<input type="checkbox"/> H35-2B075NYI
100	32	135	41	12.2						100	<input type="checkbox"/> H35-2B100TPB
100	32	135	41	12.2						100	<input type="checkbox"/> H35-2B100UPB
100	32	135	41	12.2						180	<input type="checkbox"/> H35-2B100NYI
125	32	158	35	12.2						110	<input type="checkbox"/> H35-2B125TPB
125	32	158	35	12.2						110	<input type="checkbox"/> H35-2B125UPB
125	32	158	35	12.2						200	<input type="checkbox"/> H35-2B125NYI
150	32	183	31	12.2						125	<input type="checkbox"/> H35-2B150TPB
150	32	183	31	12.2						125	<input type="checkbox"/> H35-2B150UPB
/N = Swivel + Total Lock											
75	32	111	45	12.2						80	<input type="checkbox"/> H35-2B075TPB/N
75	32	111	45	12.2						80	<input type="checkbox"/> H35-2B075UPB/N
75	32	111	45	12.2						150	<input type="checkbox"/> H35-2B075NYI/N
100	32	135	41	12.2						100	<input type="checkbox"/> H35-2B100TPB/N
100	32	135	41	12.2						100	<input type="checkbox"/> H35-2B100UPB/N
100	32	135	41	12.2						180	<input type="checkbox"/> H35-2B100NYI/N
125	32	158	35	12.2						110	<input type="checkbox"/> H35-2B125TPB/N
125	32	158	35	12.2						110	<input type="checkbox"/> H35-2B125UPB/N
125	32	158	35	12.2						200	<input type="checkbox"/> H35-2B125NYI/N
150	32	183	31	12.2						125	<input type="checkbox"/> H35-2B150TPB/N
150	32	183	31	12.2						125	<input type="checkbox"/> H35-2B150UPB/N
/D = Swivel + Directional Lock											
75	32	111	45	12.2						80	<input type="checkbox"/> H35-2B075TPB/D
75	32	111	45	12.2						80	<input type="checkbox"/> H35-2B075UPB/D
75	32	111	45	12.2						150	<input type="checkbox"/> H35-2B075NYI/D
100	32	135	41	12.2						100	<input type="checkbox"/> H35-2B100TPB/D
100	32	135	41	12.2						100	<input type="checkbox"/> H35-2B100UPB/D
100	32	135	41	12.2						180	<input type="checkbox"/> H35-2B100NYI/D
125	32	158	35	12.2						110	<input type="checkbox"/> H35-2B125TPB/D
125	32	158	35	12.2						110	<input type="checkbox"/> H35-2B125UPB/D
125	32	158	35	12.2						200	<input type="checkbox"/> H35-2B125NYI/D
150	32	183	31	12.2						125	<input type="checkbox"/> H35-2B150TPB/D
150	32	183	31	12.2						125	<input type="checkbox"/> H35-2B150UPB/D

*Color for reference only.

* Please refer to P.14 for more details.

* Static Loading: 2 times



Zinc finish

Pedal Options
/D = Swivel + Directional Lock (plastic pedal)
/N = Swivel + Total Lock (plastic pedal)
/X = Swivel + Total Lock (metal pedal)

UPB
PU wheel with precision ball bearing

TPB
TPR wheel with precision ball bearing

UPI
PU wheel with POM bushing

TPI
TPR wheel with POM bushing

NYI
Nylon (polyamide) with POM bushing

H35 Series - Solid Stem

- Pressed steel housing
- Double steel ball raceway in swivel head
- Stainless steel type (#304) is available (Item code: H35S)

Approved by
EN12530



Item Code

Swivel												
75	32	111	45							28 x 45	80	<input type="checkbox"/> H35-6S075TPB
75	32	111	45							28 x 45	80	<input type="checkbox"/> H35-6S075UPB
75	32	111	45							28 x 45	150	<input type="checkbox"/> H35-6S075NYI
100	32	135	41							28 x 45	100	<input type="checkbox"/> H35-6S100TPB
100	32	135	41							28 x 45	100	<input type="checkbox"/> H35-6S100UPB
100	32	135	41							28 x 45	180	<input type="checkbox"/> H35-6S100NYI
125	32	158	35							28 x 45	110	<input type="checkbox"/> H35-6S125TPB
125	32	158	35							28 x 45	110	<input type="checkbox"/> H35-6S125UPB
125	32	158	35							28 x 45	200	<input type="checkbox"/> H35-6S125NYI
150	32	183	31							28 x 45	125	<input type="checkbox"/> H35-6S150TPB
150	32	183	31							28 x 45	125	<input type="checkbox"/> H35-6S150UPB
/N = Swivel + Total Lock												
75	32	111	45							28 x 45	80	<input type="checkbox"/> H35-6S075TPB/N
75	32	111	45							28 x 45	80	<input type="checkbox"/> H35-6S075UPB/N
75	32	111	45							28 x 45	150	<input type="checkbox"/> H35-6S075NYI/N
100	32	135	41							28 x 45	100	<input type="checkbox"/> H35-6S100TPB/N
100	32	135	41							28 x 45	100	<input type="checkbox"/> H35-6S100UPB/N
100	32	135	41							28 x 45	180	<input type="checkbox"/> H35-6S100NYI/N
125	32	158	35							28 x 45	110	<input type="checkbox"/> H35-6S125TPB/N
125	32	158	35							28 x 45	110	<input type="checkbox"/> H35-6S125UPB/N
125	32	158	35							28 x 45	200	<input type="checkbox"/> H35-6S125NYI/N
150	32	183	31							28 x 45	125	<input type="checkbox"/> H35-6S150TPB/N
150	32	183	31							28 x 45	125	<input type="checkbox"/> H35-6S150UPB/N
/D = Swivel + Directional Lock												
75	32	111	45							28 x 45	80	<input type="checkbox"/> H35-6S075TPB/D
75	32	111	45							28 x 45	80	<input type="checkbox"/> H35-6S075UPB/D
75	32	111	45							28 x 45	150	<input type="checkbox"/> H35-6S075NYI/D
100	32	135	41							28 x 45	100	<input type="checkbox"/> H35-6S100TPB/D
100	32	135	41							28 x 45	100	<input type="checkbox"/> H35-6S100UPB/D
100	32	135	41							28 x 45	180	<input type="checkbox"/> H35-6S100NYI/D
125	32	158	35							28 x 45	110	<input type="checkbox"/> H35-6S125TPB/D
125	32	158	35							28 x 45	110	<input type="checkbox"/> H35-6S125UPB/D
125	32	158	35							28 x 45	200	<input type="checkbox"/> H35-6S125NYI/D
150	32	183	31							28 x 45	125	<input type="checkbox"/> H35-6S150TPB/D
150	32	183	31							28 x 45	125	<input type="checkbox"/> H35-6S150UPB/D

*Color for reference only.

* Please refer to P.13 for more details.

* Static Loading: 2 times



Zinc finish

Pedal Options
/D = Swivel + Directional Lock (plastic pedal)
/N = Swivel + Total Lock (plastic pedal)
/X = Swivel + Total Lock (metal pedal)

UPB
PU wheel with precision ball bearing

TPB
TPR wheel with precision ball bearing

UPI
PU wheel with POM bushing

TPI
TPR wheel with POM bushing

NYI
Nylon (polyamide) with POM bushing

H25/H26 Series - Plate

- Pressed steel housing
- Double steel ball raceway in swivel head
- Brake design for both wheel lock and directional lock
- Stainless steel type (#304) is available (Item code: H25S/H26S)

Approved by
EN12530



Swivel

75	25	102	30	95 x 70	78 x 44.5 to 74 x 44.5	9	40	<input type="checkbox"/> H25-15P075TPB
75	25	102	30	95 x 70	78 x 44.5 to 74 x 44.5	9	40	<input type="checkbox"/> H25-15P075UPB
75	25	102	30	95 x 70	78 x 44.5 to 74 x 44.5	9	70	<input type="checkbox"/> H25-15P075NYP
100	25	127	30	95 x 70	78 x 44.5 to 74 x 44.5	9	50	<input type="checkbox"/> H25-15P100TPB
100	25	127	30	95 x 70	78 x 44.5 to 74 x 44.5	9	50	<input type="checkbox"/> H25-15P100UPB
125	25	152	30	95 x 70	78 x 44.5 to 74 x 44.5	9	60	<input type="checkbox"/> H25-15P125TPP
125	25	152	30	95 x 70	78 x 44.5 to 74 x 44.5	9	60	<input type="checkbox"/> H25-15P125UPP



/N = Swivel + Total Lock

75	25	102	30	95 x 70	78 x 44.5 to 74 x 44.5	9	40	<input type="checkbox"/> H25-15P075TPB/N
75	25	102	30	95 x 70	78 x 44.5 to 74 x 44.5	9	40	<input type="checkbox"/> H25-15P075UPB/N
75	25	102	30	95 x 70	78 x 44.5 to 74 x 44.5	9	70	<input type="checkbox"/> H25-15P075NYP/N
100	25	127	30	95 x 70	78 x 44.5 to 74 x 44.5	9	50	<input type="checkbox"/> H25-15P100TPB/N
100	25	127	30	95 x 70	78 x 44.5 to 74 x 44.5	9	50	<input type="checkbox"/> H25-15P100UPB/N
125	25	152	30	95 x 70	78 x 44.5 to 74 x 44.5	9	60	<input type="checkbox"/> H25-15P125TPP/N
125	25	152	30	95 x 70	78 x 44.5 to 74 x 44.5	9	60	<input type="checkbox"/> H25-15P125UPP/N



Fixed

75	25	102	30	95 x 70	78 x 44.5 to 74 x 44.5	9	40	<input type="checkbox"/> H26-15P075TPB
75	25	102	30	95 x 70	78 x 44.5 to 74 x 44.5	9	40	<input type="checkbox"/> H26-15P075UPB
75	25	102	30	95 x 70	78 x 44.5 to 74 x 44.5	9	70	<input type="checkbox"/> H26-15P075NYP
100	25	127	30	95 x 70	78 x 44.5 to 74 x 44.5	9	50	<input type="checkbox"/> H26-15P100TPB
100	25	127	30	95 x 70	78 x 44.5 to 74 x 44.5	9	50	<input type="checkbox"/> H26-15P100UPB
125	25	152	30	95 x 70	78 x 44.5 to 74 x 44.5	9	60	<input type="checkbox"/> H26-15P125TPP
125	25	152	30	95 x 70	78 x 44.5 to 74 x 44.5	9	60	<input type="checkbox"/> H26-15P125UPP



* Static Loading: 2 times

Plate Size (mm)

	Plate Size	Bolt Hole Spacing	Bolt Hole Dia.
15P	95 x 70	44.5 x 74~78	9

*Color for reference only.



Zinc finish

UPB
Polyurethane on polypropylene with precision ball bearing

TPB
Thermoplastic rubber on polypropylene with precision ball bearing

UPP
PU wheel with plain bearing
TPP
TPR wheel with plain bearing

NYP
Nylon (polyamide) with plain bearing

H25 Series - Threaded Stem

- Pressed steel housing
- Double steel ball raceway in swivel head
- Brake design for both wheel lock and directional lock
- Grip ring stem is available
- Stainless steel type (#304) is available (Item code: H25S)

Approved by
EN12530



Swivel

75	25	99	30	M10 x 25					40	<input type="checkbox"/> H25-3T075TPB
75	25	99	30	M10 x 25					40	<input type="checkbox"/> H25-3T075UPB
75	25	99	30	M10 x 25					70	<input type="checkbox"/> H25-3T075NYP
100	25	125	30	M10 x 25					50	<input type="checkbox"/> H25-3T100TPB
100	25	125	30	M10 x 25					50	<input type="checkbox"/> H25-3T100UPB
125	25	150	30	M10 x 25					60	<input type="checkbox"/> H25-3T125TPP
125	25	150	30	M10 x 25					60	<input type="checkbox"/> H25-3T125UPP



/N = Swivel + Total Lock

75	25	99	30	M10 x 25					40	<input type="checkbox"/> H25-3T075TPB/N
75	25	99	30	M10 x 25					40	<input type="checkbox"/> H25-3T075UPB/N
75	25	99	30	M10 x 25					70	<input type="checkbox"/> H25-3T075NYP/N
100	25	125	30	M10 x 25					50	<input type="checkbox"/> H25-3T100TPB/N
100	25	125	30	M10 x 25					50	<input type="checkbox"/> H25-3T100UPB/N
125	25	150	30	M10 x 25					60	<input type="checkbox"/> H25-3T125TPP/N
125	25	150	30	M10 x 25					60	<input type="checkbox"/> H25-3T125UPP/N



* Static Loading: 2 times

Threaded Stem Size (mm)

	Dia. x Length	Grip Ring Stem Size (mm)	Dia. x Length
2T	1/2"-13UNC x 25	2F	Ø11 x 25
3T	M10 x 25 P=1.5	6F	Ø11 x 35

*Color for reference only.



Zinc finish

UPB
Polyurethane on polypropylene with precision ball bearing

TPB
Thermoplastic rubber on polypropylene with precision ball bearing

UPP
PU wheel with plain bearing
TPP
TPR wheel with plain bearing

NYP
Nylon (polyamide) with plain bearing

H25 Series - Bolt Hole

- Pressed steel housing
- Double steel ball raceway in swivel head
- Brake design for both wheel lock and directional lock
- Stainless steel type (#304) is available (Item code: H25S)

Approved by
EN12530

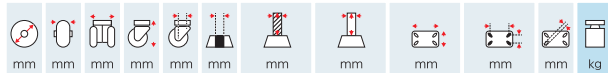

Item Code

Swivel

75	25	99	30	10.2								40	<input type="checkbox"/> H25-1B075TPB
75	25	99	30	10.2								40	<input type="checkbox"/> H25-1B075UPB
75	25	99	30	10.2								70	<input type="checkbox"/> H25-1B075NYP
100	25	125	30	10.2								50	<input type="checkbox"/> H25-1B100TPB
100	25	125	30	10.2								50	<input type="checkbox"/> H25-1B100UPB
125	25	150	30	10.2								60	<input type="checkbox"/> H25-1B125TPP
125	25	150	30	10.2								60	<input type="checkbox"/> H25-1B125UPP



/N = Swivel + Total Lock

75	25	99	30	10.2								40	<input type="checkbox"/> H25-1B075TPB/N
75	25	99	30	10.2								40	<input type="checkbox"/> H25-1B075UPB/N
75	25	99	30	10.2								70	<input type="checkbox"/> H25-1B075NYP/N
100	25	125	30	10.2								50	<input type="checkbox"/> H25-1B100TPB/N
100	25	125	30	10.2								50	<input type="checkbox"/> H25-1B100UPB/N
125	25	150	30	10.2								60	<input type="checkbox"/> H25-1B125TPP/N
125	25	150	30	10.2								60	<input type="checkbox"/> H25-1B125UPP/N



* Static Loading: 2 times

H22 Series - Plate

- Pressed steel housing
- Double steel ball raceway in swivel head
- Side brake or front brake for wheel lock only

Approved by
EN12530



Item Code

Swivel

50	20	66	21							50 x 50	38.5 x 38.5	6.5	32	<input type="checkbox"/> H22-10P50TPP
50	20	66	21							50 x 50	38.5 x 38.5	6.5	36	<input type="checkbox"/> H22-10P50UPP
50	20	66	21							50 x 50	38.5 x 38.5	6.5	40	<input type="checkbox"/> H22-10P50NYP



/N = Swivel + Front Brake (Wheel Lock Only)

50	20	66	21							50 x 50	38.5 x 38.5	6.5	32	<input type="checkbox"/> H22-10P50TPP/N
50	20	66	21							50 x 50	38.5 x 38.5	6.5	36	<input type="checkbox"/> H22-10P50UPP/N
50	20	66	21							50 x 50	38.5 x 38.5	6.5	40	<input type="checkbox"/> H22-10P50NYP/N



/S = Swivel + Side Brake (Wheel Lock Only)

50	20	66	21							50 x 50	38.5 x 38.5	6.5	32	<input type="checkbox"/> H22-10P50TPP/S
50	20	66	21							50 x 50	38.5 x 38.5	6.5	36	<input type="checkbox"/> H22-10P50UPP/S
50	20	66	21							50 x 50	38.5 x 38.5	6.5	40	<input type="checkbox"/> H22-10P50NYP/S



* Static Loading: 2 times

Bolt Hole Size (mm)

	Dia.
1B	10.2

*Color for reference only.

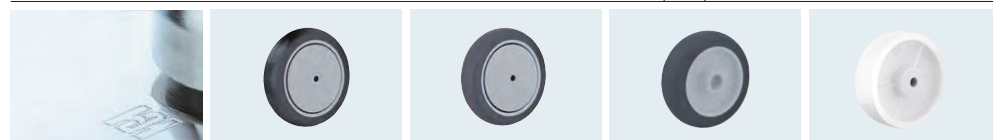

Zinc finish

UPB
Polyurethane on polypropylene with precision ball bearing

TPB
Thermoplastic rubber on polypropylene with precision ball bearing

UPP
PU wheel with plain bearing
TPP
TPR wheel with plain bearing

NYP
Nylon (polyamide) with plain bearing

Plate Size (mm)

	Plate Size	Bolt Hole Spacing	Bolt Hole Dia.
10P	50 x 50	38.5 x 38.5	6.5

*Color for reference only.

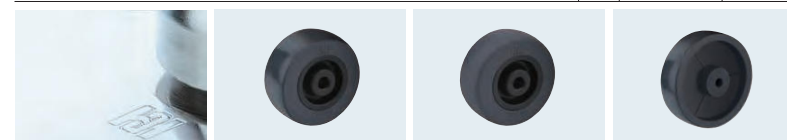

Zinc finish

UPP
Polyurethane on polypropylene with plain bearing

TPP
Thermoplastic rubber on polypropylene with plain bearing

NYP
Nylon (polyamide) with plain bearing

H22 Series - Threaded Stem

- Pressed steel housing
- Double steel ball raceway in swivel head
- Side brake or front brake for wheel lock only
- Grip ring stem is available

Approved by
EN12530



Item Code

Swivel												
50	20		67	21	M8 x 15						32	<input type="checkbox"/> H22-15T50TPP
50	20		67	21	M8 x 15						36	<input type="checkbox"/> H22-15T50UPP
50	20		67	21	M8 x 15						40	<input type="checkbox"/> H22-15T50NYP

/N = Swivel + Front Brake (Wheel Lock Only)												
50	20		67	21	M8 x 15						32	<input type="checkbox"/> H22-15T50TPP/N
50	20		67	21	M8 x 15						36	<input type="checkbox"/> H22-15T50UPP/N
50	20		67	21	M8 x 15						40	<input type="checkbox"/> H22-15T50NYP/N

/S = Swivel + Side Brake (Wheel Lock Only)												
50	20		67	21	M8 x 15						32	<input type="checkbox"/> H22-15T50TPP/S
50	20		67	21	M8 x 15						36	<input type="checkbox"/> H22-15T50UPP/S
50	20		67	21	M8 x 15						40	<input type="checkbox"/> H22-15T50NYP/S

★ Static Loading: 2 times

H22 Series - Bolt Hole

- Pressed steel housing
- Double steel ball raceway in swivel head
- Side brake or front brake for wheel lock only

Approved by
EN12530



Item Code

Swivel												
50	20		66	21	10.2						32	<input type="checkbox"/> H22-1B50TPP
50	20		66	21	10.2						36	<input type="checkbox"/> H22-1B50UPP
50	20		66	21	10.2						40	<input type="checkbox"/> H22-1B50NYP

/N = Swivel + Front Brake (Wheel Lock Only)												
50	20		66	21	10.2						32	<input type="checkbox"/> H22-1B50TPP/N
50	20		66	21	10.2						36	<input type="checkbox"/> H22-1B50UPP/N
50	20		66	21	10.2						40	<input type="checkbox"/> H22-1B50NYP/N

/S = Swivel + Side Brake (Wheel Lock Only)												
50	20		66	21	10.2						32	<input type="checkbox"/> H22-1B50TPP/S
50	20		66	21	10.2						36	<input type="checkbox"/> H22-1B50UPP/S
50	20		66	21	10.2						40	<input type="checkbox"/> H22-1B50NYP/S

★ Static Loading: 2 times

Threaded Stem Size (mm)

	Dia. x Length		Dia. x Length
1T	3/8"-16UNC x 25	2F	Ø11 x 25
3T	M10 x 25 P=1.5	6F	Ø11 x 35
35T	5/16"-18UNC x 25		

Grip Ring Stem Size (mm)

Bolt Hole Size (mm)

	Dia.
1B	10.2
4B	8.2

*Color for reference only.

*Color for reference only.

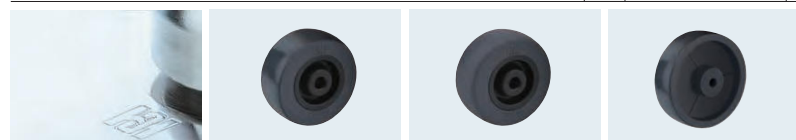

Zinc finish

UPP
Polyurethane on polypropylene with plain bearing

TPP
Thermoplastic rubber on polypropylene with plain bearing

NYP
Nylon (polyamide) with plain bearing

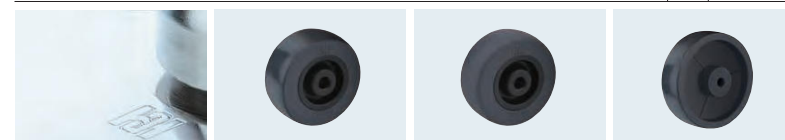

Zinc finish

UPP
Polyurethane on polypropylene with plain bearing

TPP
Thermoplastic rubber on polypropylene with plain bearing

NYP
Nylon (polyamide) with plain bearing

Wheel Selection Advice

PU Wheels

Polyurethane (PU) is used in a wide variety of wheel surfaces, including medical and industrial castors, due to its excellent durability and high loading capacity. Our PU castors also feature precision ball bearings, ensuring perfectly smooth, silent movement. These castors will not leave marks on floor surfaces, even under heavy loading.

However, PU has weaker hydrolytic stability. As a result, the durability of PU wheels may be affected by humid environments, along with the cleaning chemicals and high temperature steam sterilization processes regularly used in hospitals. In addition, a PU surface will gradually harden and degrade if kept in a cold environment ($< 0^{\circ}$ Celsius) for long periods of time.

TPR Wheels

Thermoplastic Rubber (TPR) is another material commonly used in wheel surfaces, including medical and industrial castors. The main advantage of a TPR wheel surface is its elasticity, which gives it good shock-absorbing properties while in motion. This makes TPR the ideal material for medical equipment castor wheels.

However, due to a softer wheel surface, TPR has a slightly lower loading capacity than PU. In addition, TPR wheel surfaces may gradually deform and consequently affect castor function if left stationary for prolonged periods under heavy loading.

Nylon Wheels

Nylon (Polyamide) is generally used in industrial castors, due to its hardness, high loading capacity and long life. However, nylon wheels create noise while moving on floor surfaces, making them unsuitable for use in hospitals and other environments where quiet is required.

Electric Conductive Wheels

Electric conductive wheels are mainly used in advanced medical equipment and the technology industry. Available in PU and TPR, electric conductive wheels comply with international standards (**Resistance $< 10^4\Omega$**). These wheels are ideal for medical devices, trolleys and hospital beds which are fitted with precision electronic instruments and frequently moved. Electric conductive wheels conduct electricity emanating from electronic devices to the floor, ensuring patient safety and protecting equipment.

Antistatic Wheels

Antistatic wheels are also available in both PU and TPR, and comply with international standards (**Resistance $< 10^8\Omega$**). Normally, static electricity is generated as a wheel moves in a dry environment - as a result, dust, hair, etc. on the floor is attracted to the wheel surface. Antistatic wheels are the perfect solution to this problem.

Nylon = Polyamide
TPR = Thermoplastic Rubber
PU = Polyurethane

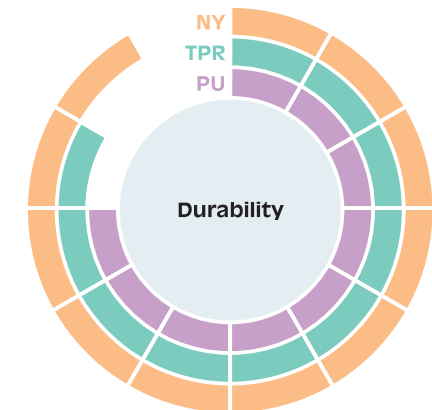
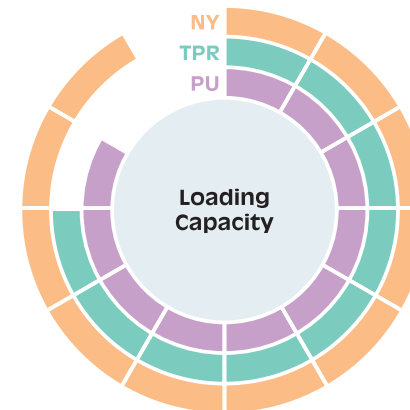
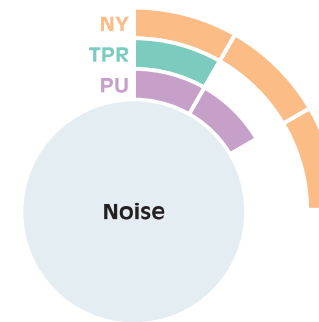

Accessories

Brake Pedal

SPP-110

DPP-190

DPP-192

Change Lever (Aluminum Alloy)

CLP-28

CLP-65

Bumper

ID 22.5, 25.5 or 32.5mm
OD 94mm



BMP225-RD
BMP255-RD
BMP325-RD
BMP225-SQ
BMP255-SQ
BMP325-SQ

Nylon Socket

For Tube ID 22mm



NSP22-RD
NSP22-SQ

Memo

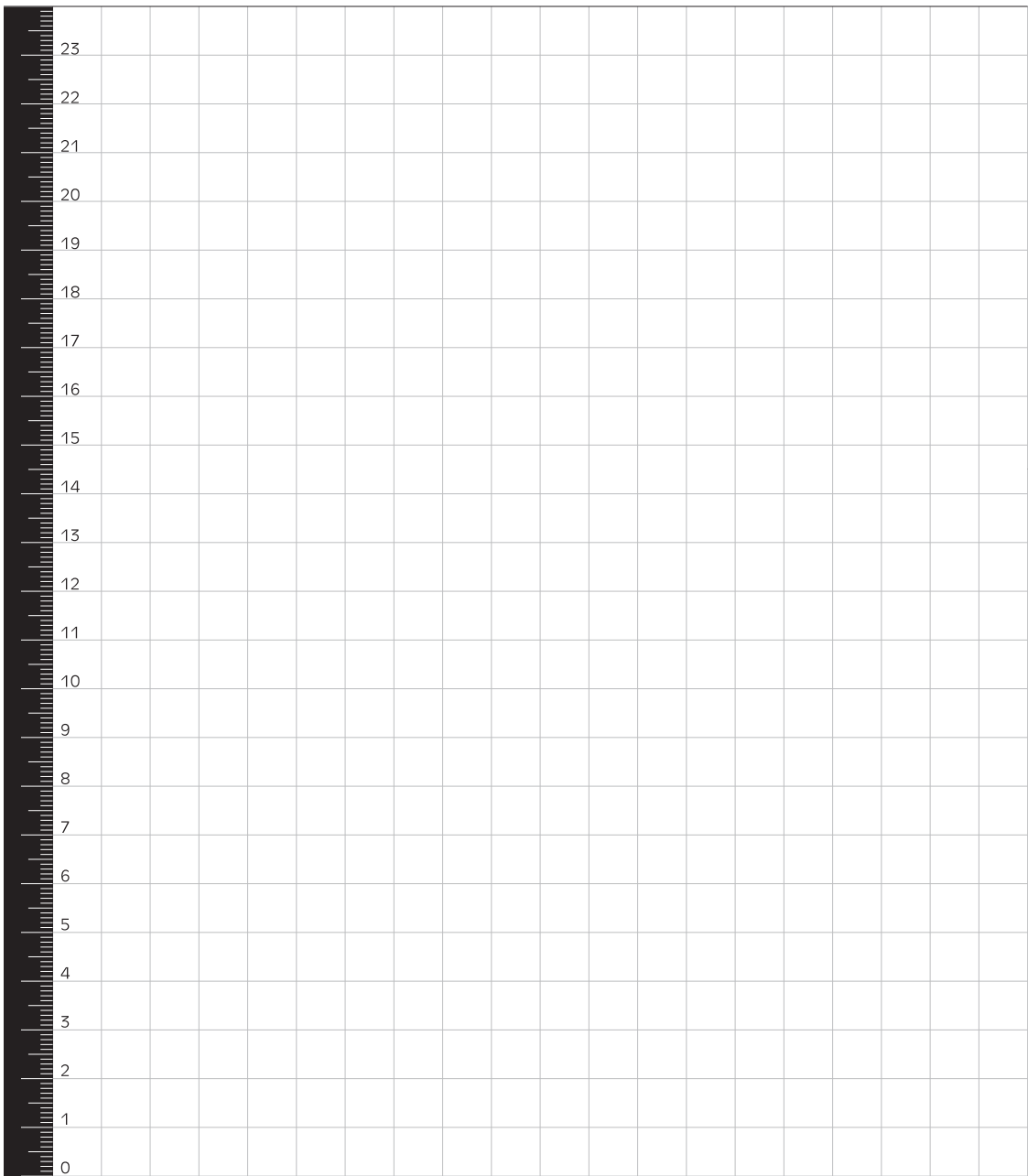

The HAION Commitment

HAION is an industry leader, committed to providing superior castor solutions and quality, personalized service for global customers.

**RAPPRESENTANTE PER L'ITALIA
GORACO SRL – MILANO**

www.goraco.com

commerciale@goraco.com

News!

Arrange a face-to-face meeting & see the latest news.

